

IDENTIFICATION

NAME

ADDRESS

CLASS

COURSE

COLLEGE ADDRESS

PHONE

EDINBORO

State Teachers College

BULLETIN

Volume XLIII

August, 1959

Number 4

SETTAM AREA

Student Handbook Issue  
1959 - 1960

EDINBORO, PENNSYLVANIA

Issued four times a year, March, April, May and August by the State Teachers College at Edinboro, Pennsylvania

Second Class mailing privilege authorized March, 1956 at the post office at Edinboro, Pennsylvania in accordance with the Act of Congress of August 24, 1912

## ALMA MATER

(Aloha)

Hail to thee, our Alma Mater glorious!  
Fresh wreathes we bring to bind thy brow.  
Trials past thou hast withstood victorious,  
Never fairer, never statelier than now.

O Edinboro, Edinboro

We revere thee, love thee, serve thee ever.  
While class speeds class,  
As swift years pass,  
To thee our hearts are true.

## EDITOR'S FOREWARD

This student handbook is compiled by a committee to be used as an aid to students in helping them to understand the functions, activities, customs, and regulations of Edinboro State Teachers College.

The editor hopes that this handbook will be a valuable source of information in helping freshmen to establish themselves as well-informed members of Edinboro State Teachers College student body. The upperclassmen will find it of use also. It is suggested that students keep their handbook in an accessible place for reference. The school calendar for 1959-60 has been carefully compiled as to the various times, dates, and meeting places of the different organizations; the editor hopes all students and organizations will adhere to it.

The gratitude of the Student Handbook Committee is extended to Rita Mazur, James Jovenall, Judy Waugh, Pat Gray, Mrs. Ruth Peck, and Mr. William Cornell for their untiring work in compiling the handbook.

Elliott C. Winograd, Editor  
Student Handbook Committee



**Dr. Thomas R. Miller**

## **COLLEGE PRESIDENT'S MESSAGE**

One hundred and two years ago some public minded citizens of Northwest Pennsylvania participated in the dedication at Edinboro of a private academy for the training of teachers. Four years later, in 1861, that academy was chartered by the Commonwealth as Pennsylvania's second Normal School. Since that time, Edinboro's function has continued to be the education of teachers and the making of provision for additional educational opportunities for the youth of this part of the state.

Teachers are particularly needed to man the schools of this state and nation. Facilities here at Edinboro are being expanded and additional faculty are being employed in order that the college may do everything in its power to meet this challenge. But, far more than facilities and faculty are needed. A spirit of dedication, a desire to serve and a willingness to work in order to learn are absolutely necessary to a successful teaching career.

Coming to this college as you do at the period of a great upsurge in enrollment, you may find both living and study conditions crowded. It will depend more upon you personally than ever before to make yourself self-sufficient. There will be more of you to share each faculty member's time and you will have to learn to become self-starters.

The students, faculty, alumni, and friends of the college have worked together to make possible many of the things which are now a part of this campus and a part of the college as a whole. Each of us shares in the total of what is already here, but each one of us has the responsibility to add his own individual contribution to this college. If each one of us will do everything within his power to retain just as many as possible of our present good qualifications, as we grow into a larger

institution with its many possibilities for an enriched and expanded program, the results can well be good for nearly all of us.

This handbook is prepared by our students and faculty to assist you in your work at this college. You are urged to read it with care, to follow its precepts carefully, to treat it as a storehouse of information to which you will make frequent reference, and to keep it as a source of guidance throughout the entire year. Read carefully the constitution of the faculty-student government body so you may know the part this organization plays in the life of the college.

It is my hope that every one of us here on campus, this year, may have a pleasant and profitable experience as we go from task to task in the total process of educating ourselves for the challenges which lie ahead.

Sincerely,



Left to right: President Larry Moses, Secretary Pat Gray, Vice President Joe Lamberti.

### WELCOME TO EDINBORO

The 1959-60 edition of the student handbook is presented in the hope that it will serve the students and the faculty members of Edinboro as a convenient reference book which contains valuable information about the college and its activities for the coming year.

On behalf of the student body, the members of the student-faculty council wish to welcome the new students to our Edinboro campus in a spirit of friendship and cooperation. The members of the council also wish everyone a very pleasant and successful college year.

Lawrence L. Moses  
President  
Student Council

## The College's 102 Year History

The beginnings of the college were laid in 1857, over one hundred years ago, when a band of Scotch-Irish farmers grouped together and founded a private normal school at Edinboro by popular subscription to train teachers. In 1861 it was chartered by the Commonwealth as Pennsylvania's second Normal School and developed and grew through service to the Commonwealth.

A great forward stride was taken in 1914, when the Commonwealth purchased Edinboro Normal School. In 1926, alerted to the need for better educated teachers for its schools, Pennsylvania made Edinboro a Teachers College offering a four-year curriculum leading to degrees of Bachelor of Science in Secondary, Elementary, and Art Education.

Beginning in September of 1957, the college was empowered to grant degrees of Master of Education in Elementary Education. This September, graduate work in secondary education has been approved for offering.

Although designed primarily to serve the counties of Erie, Crawford, Mercer, Warren, and Venango, Edinboro receives and welcomes students from every section of the state.

The control of the College is vested in the Board of Trustees, composed of nine members appointed by the Governor of Pennsylvania. The Board of Trustees in turn elects the President of the College who is responsible for its administration. The State Superintendent of Public Instruction is an ex-officio member of the Board of Trustees.

The college is accredited by the American Association of Colleges for Teacher Education, the Middle States Association of Colleges and Secondary Schools, and the American Medical Association. In addition, its curriculums are registered by the New York State Department of Education.

## THE FACULTY AND STAFF

### Administration and Instructional

Thomas R. Miller, Ph.D	.....	President
Normal Hall	Tel. 3301 Ext. 71	or 3151
Nancy Acker	.....	Physical Education
Crawford Gym	Tel. 3301 Ext. 89	
Louise Barber, M.A.	.....	Second Grade
Compton School 101	Tel. 2422 or 2313	
Justina Baron, M.A.	.....	Ass't. Librarian
Normal Hall Library	Tel. 3301 Ext. 87	
George R. Bond, Ed.D	.....	English
Music Hall F	Tel. 3301	
William T. Brown, M.S.	.....	Art
Loveland Hall 7	Tel. 3301 Ext. 84	
Ralph D. Bruce, M.A.	.....	Art
Loveland Hall 2	Tel. 3301 Ext. 84 or 2021	
Mildred Bruce, M.Ed.	.....	Art
Loveland Hall, Conference Room	Tel. 3301 Ext. 81 or 2021	
Esther W. Campbell, M.A.	.....	Music
Memorial Auditorium	Tel. 3301 or 4974	
Nancy A. Carlson, B.S.	.....	Ass't. Dean of Women
New Dorm	Tel. 3301 Ext. 91	
Eileen Cassidy, R.N.	.....	Nurse
Haven Hall Infirmary	Tel. 3301 Ext. 79	
Sam C. Cianflocco, B.S.	.....	Social Studies
Music Hall	Tel. 3301 Ext. 92	
James Coffman, M.S.	.....	Science
Loveland Hall 8	Tel. 3301 Ext. 84 or 2023	
Robert E. Connors, Ed.D	.....	Education
Normal Hall B	Tel. 3301 Ext. 75	
*William A. Cornell, M.A.,	.....	Admissions Director
Normal Hall	Tel. 3301 Ext. 81 or 5105	
Aime H. Doucette, M.Ed.	.....	Art
Loveland Hall, Main	Tel. 3301 Ext. 84 or 5733	
Mildred Forness, M.A.	.....	Librarian
Normal Hall Library	Tel. 3301 Ext. 87 or 2313	
John T. Gatz, Ed.D	.....	Science
Loveland Hall	Tel. 3301 Ext. 89 or 2875	
Charles H. Glendinning, M.A.	.....	English
Normal Hall 20F	Tel. 3301 or 3171	
*On Leave Second Semester		

B. Wycliffe Griffin, M.A. .... Social Studies  
 Music Hall D Tel. 3301 Ext. 92 or 2745  
 \*Ruth Harris, M.A. .... English  
 Music Hall J Tel. 3301 Ext. 92  
 Luther V. Hendricks, Ph.D ... Social Studies  
 Music Hall A Tel. 3301 Ext. 92 or 5497  
 Vaughn E. Herbel ..... Business Manager  
 Normal Hall Tel. 3301 Ext. 76  
 William S. Herr, M.Litt. .... Education  
 Normal Hall 20D, Tel. 3301 Ext. 75 or 3755  
 James R. Hill, M.A., High School Soc. Studies  
 Compton School 200 Tel. 2422 or 2955  
 Jean L. Holcombe, M.A. .... English  
 Music Hall Tel. 3301 Ext. 92  
 John C. Hoshauer, Ed.D ..... Mathematics  
 Normal Hall 3A Tel. 3301 Ext. 75 or 4833  
 Curtis L. Ickes, M.Ed. .... Mathematics  
 Normal Hall 20E Tel. 3301 or 5372  
 Mark C. Jackson, M.S.  
 High School Math, Science  
 Compton School 201 Tel. 2422 or 2432  
 Francis R. Johnson, M.Ed. .... Speech  
 Normal Hall 20C Tel. 3301 Ext. 75 or 5101  
 Henry Katzwinkel, B.S. .... Art  
 Loveland Hall 1 Tel. 3301 Ext. 84  
 Erneset R. LaFollette, Ph.D .... Education  
 Normal Hall 3B Tel. 3301 Ext. 75 or 2025  
 Glen C. Law, Ed.D ..... Music  
 Memorial Auditorium Tel. 3301  
 Suzanne Lego, R.N. .... Nurse  
 Haven Hall Infirmary Tel. 3301 Ext. 79  
 Edwin Linden, M.Ed., High School Soc. Studies  
 Compton School 202 Tel. 2422 or 5492  
 Harriet Long, Ph.D ..... Geography  
 Recitation Hall 6 Tel. 3301 or 2133  
 Jane Ludgate, M.A. .... Speech  
 Memorial Auditorium Tel. 3301 or 4732  
 Arthur L. McComb, M.Ed. Health, Phys. Ed.  
 Crawford Gymnasium 1  
 Tel. 3301 Ext. 89 or 2731  
 Ronald McIntyre, B.S. ... Physical Education  
 Crawford Gymnasium Tel. 3301 Ext. 89  
 \*On Leave Second Semester

H.W. McNees, M.S. .... Science  
 Loveland Hall 10 Tel. 3301 Ext. 84 or 2521  
 John F. Mehner, Ph. D ..... Science  
 Loveland Hall Tel. 3301 Ext. 24  
 Richard Mower, M.A. .... Art  
 Loveland Hall 5 Tel. 3301 Ext. 84  
 Helen Nicely, M.A. .... English  
 Normal Hall 3D Tel. 3301 Ext. 75 or 2821  
 Sybil P. Odell, M.Ed. .... Public School Art  
 Compton School, Art Rm.  
 Tel. 2422 or 2815  
 Herman Offner, Ph. D ... Dean of Instruction  
 Normal Hall Tel. 3301 Ext. 75 or 2792  
 Ruth Peck, M.A. .... Dean of Women  
 Haven Hall Tel. 3301 Ext. 78  
 Joseph Pizzat, Ed.D ..... Art  
 Loveland Hall, Conference Room  
 Tel. 3301 Ext. 84  
 Leo Roland, Ed.D ..... Education  
 Normal Hall Tel. 3301 Ext. 75  
 Emma Rossbacher, B.S. .... Librarian  
 Library Tel. 3301 Ext. 87  
 John S. Schell, Ph.D ..... Psychology  
 Tel. 3301  
 Edna M. Shenk, M.Ed. .... Sixth Grade  
 Normal Hall 3D Tel. 3301 Ext. 75 or 2334  
 Alice Schuster, Ph.D ..... Social Studies  
 Music Hall C Tel. 3301 Ext. 92  
 James Smith, M.S. .... Dean of Men  
 Reeder Hall 26 Tel. 301 Ext. 83  
 Ray Stapp, M.A. .... Art  
 Loveland Hall 1 Tel. 3301 Ext. 84 or 2722  
 Wayne T. Thompson, Ph.D ... Social Studies  
 Music Hall G Tel. 3301 Ext. 92 or 2833  
 Robert W. Thurbon, B.S., Science and Athletics  
 Crawford Gym 1  
 Tel. 3301 Ext. 89 or Ext. 82  
 Leland W. Van Laningham, Ed.D Education  
 Compton School, Placement Office  
 Tel. 3301 Ext. 90 or 2332  
 Lawrence C. Vincent, M.A. .... Speech  
 Memorial Auditorium Tel. 3301 or 2611

C. Frances Whitney, M.A. . . . . Education  
 Normal Hall 20           Tel. 3301 or 2073  
 R. Joseph Wraight, Ph.D . . . . . Geography  
   Tel. 3301  
 Carl L. Wozniak, M. Litt. . . . . Social Studies  
 Music Hall A.       Tel. 3301 Ext. 92 or 2531

**NON-INSTRUCTIONAL STAFF**

**Secretarial**

Mrs. June Connors       Sec'y. to the President  
 Mrs. Marjory Koon   Sec'y. to Dean of Inst.  
 Mrs. Retha Kibler   Sec'y. to Admissions Dir.  
 Mrs. Cora Hostetler   Clerk, Business Office  
 Mrs. Mary Lou Minch   Clerk, Business Office  
 Mrs. Mary A. Warner   Clerk, Business Office  
 Mrs. Rosemarie Henderson  
   Clerk, Dean's Office  
 Miss Patricia Falkowski   Clerk, Dean's Office  
 Miss Romona Lewis       Clerk, Dean's Office

**Buildings and Grounds**

Harold Mallory           Building Engineer  
                   Boiler House           Tel. 3301 Ext. 88  
 Howard Hanks           Maintenance Foreman  
 Mrs. Elizabeth Egloff       Housekeeper  
 Herman Weidenheft, Cust.   Normal Hall  
 Angleo Talmo, Cust.       Memorial Auditorium  
 Mrs. Gertrude Pettit, Cust.   Haven Hall  
 Mrs. Mary Stafford, Cust.   Reeder Hall  
 Mrs. Anna Polesnak, Cust.   New Dormitory  
 George Kraus, Cust.       Loveland Hall  
 George Bjork, Cust.       Crawford Gymnasium  
 Ernest Meecham           Storekeeper  
 Richard Glenn           Watchman

**Food Service**

Ingermann E. Peterson           Manager  
                   Haven Hall Dining Room  
                                   Tel. 3301 Ext. 80 or 5201

**GENERAL**

**INFORMATION**

### Telephone Service

All incoming telephone calls to the College are received in the main office of Normal Hall from 8:30 to 5:00 on Mondays through Fridays and from 8:30 to 12:00 on Saturday. At all other times calls are received through Haven Hall. The College's private exchange is Edinboro 3301. Calls to the various extensions throughout the College can be dialed from other extensions. If calling from outside the college, the extension number should be given to the person answering the phone. Off campus calls can be made through station 70 from 8:30 to 5:00 Monday through Friday and from 8:30 to 12:00 Saturday and through station 78 at all other times. To make local calls off campus, students may use extension 78 in Haven Hall. Dial 0, wait for dial tone and dial desired number. Pay phones on campus are to be used for long distance calls.

### On Campus Extensions

Admissions Office .....	81
Boiler House .....	88
Bursar .....	76
Dean of Instruction's Office .....	75
Dean of Men .....	75
Dean of Women .....	78
East Hall .....	77
Gymnasium .....	89
Haven Hall .....	78 & 85
Infirmary .....	79
Kitchen .....	80
Library .....	87
Loveland Hall .....	84
Music Hall .....	92
New Dorm .....	91
Placement Service .....	90
President's Office .....	71
President's Secretary .....	70
Reeder Hall .....	83
Storeroom .....	86
Mr. Thurbon's Apartment .....	82

### Other Campus Phones

A. L. Mathias Co. (food service) .....	5201
Conneauttee House .....	9041
Cussewago House .....	9571
East Hall .....	9541
Haven Hall .....	9401
LeBoeuf House .....	9031
Mead House .....	9021
New Dormitory .....	9531
Reeder Hall .....	9434
State House .....	9511
Student Union .....	9051
Tionesta House .....	9421
Venango House .....	9011
White Hall .....	9901
B.S.A. Office, Boiler House .....	4491
Kinzua House .....	9991
Mrs. Peck, Dean of Women .....	3622



## Tips to the Freshmen

Freshmen at Edinboro are expected to conduct themselves in accordance with the standards normally adhered to by self-respecting, educated men and women. Students must never forget that they are being educated to become teachers of American youth.

The faculty at Edinboro stands ready to assist every student to cultivate habits of study application, self-control, a sense of human and profound interest in furthering the high ideals traditionally a part of Edinboro College.

In order to gain a feeling of being a part of Edinboro College, freshmen and upper classmen, should practice the following:

1. Always be ready with a cheerful, courteous greeting for your fellow students, faculty members, and visitors on the campus.
2. Develop the Edinboro College spirit. You must believe that Edinboro is the finest college, and that your class is the best class, and try to make yourself the best student.
3. Be courteous and observe the best rules of etiquette at all times.
4. Always present a well-groomed appearance.
5. Attend classes and assemblies regularly.
6. Attend the church services of your faith.
7. Plan for, and get eight hours of sleep every night.
8. Be careful of your personal property. Label all your property with your name.

The college reserves the right to suspend or dismiss any student whose influence or conduct is found to be injurious to the high standard of morals and scholarship of the student body, or whose conduct is prejudicial to the good name of the college.

## FRESHMEN CUSTOMS

By observing freshman customs in the proper spirit every student can acquire the qualities which will make him a worthy mem-

ber of his college — an attitude of friendliness towards all other college students, a respect for the standards and traditions of his school, and a familiarity with the things that constitute its own special trademark, i.e., its cheers, its Alma Mater and other songs. In addition, the new student will learn that he belongs not only to the freshman class, but to the college as a whole.

## CUSTOMS REGULATIONS

1. Signs and dinks must be worn until the bonfire on Friday, October 2.
2. All freshmen students are required to march in the homecoming Parade on Saturday, October 3. Dinks are required to be worn for this event!
3. Dinks must be worn until half-time of the Homecoming football game.

Neither dinks nor signs need to be worn on Sundays.

## CUSTOMS

1. Wear dinks and sign, and carry the Edinboro Handbook. (8:00 a.m. — 5 p.m.)
2. Wear dinks to pep rallies.
3. Learn the school song.
4. Learn the various cheers.
5. Attend all football games and pep rallies.
6. Attend all Freshmen Tribunal meetings.
7. Refrain from walking on the campus lawn.
8. Greet each upperclassmen in a courteous manner.
9. Ask upperclassmen to dine with you at lunch.
10. Perform various services in the dining hall, such as getting ice water, seating women, etc.
11. Relinquish seats in the Union to upperclassmen.

## College Assemblies

A series of college assemblies is presented during the school year. These assemblies are normally held on Wednesday mornings in the auditorium. A number of evening programs are also presented.

A committee of faculty members and students plans both morning and evening programs. It is the purpose of these programs to supplement and enrich the curricular offerings of the college.

Freshmen and sophomores are required to attend morning assemblies. Seats are assigned and attendance is checked. The list of absentees is filed in the office of the Dean of Instruction. Each unexcused absence from a morning assembly lowers by one point the total accumulation of quality points which the student has earned towards graduation.

## Time Schedule of Classes

PERIOD	TIME
First .....	8:00 - 8:50 a.m.
Second .....	8:55 - 9:45 a.m.
Third .....	9:50 - 10:40 a.m.
Fourth .....	10:45 - 11:35 a.m.
Fifth .....	11:40 - 12:30 p.m.
Sixth .....	12:35 - 1:25 p.m.
Seventh .....	1:30 - 2:20 p.m.
Eighth .....	2:25 - 3:15 p.m.
Ninth .....	3:20 - 4:10 p.m.

## Registration

Students are reminded to register and pay fees on the assigned dates. All fees must be paid in advance. Permission must be obtained from the President of the College in advance to avoid penalty for late payment.

Dates of registration and payment of fees may be found in the Calendar printed in the back of this Handbook.

## Withdrawal Procedure

Any student finding it necessary to withdraw from college at a time other than the close of a semester should report to the office of the Dean of Instruction, the Bursar, and the Dean of Men or Dean of Women prior to departure.

## Academic Standards

### GRADING SYSTEM

Standings indicating the quality of work are:

- "A" (92-100)—grade given to students whose work is clearly of an exceptional nature.
- "B" (87- 91)—grade given to students who do distinctly superior work.
- "C" (80- 86)—grade representing work of satisfactory quality.
- "D" (75- 79)—grade indicating unsatisfactory work.
- "F" ( 0- 75)—grade indicating failure. Any course in which an "F" grade has been earned must be repeated.
- "X" —not a grade, but a mark indicating that the student, for justifiable cause, has not been able to complete the required work within the time limit.

## THE DEAN'S LIST

Twice a year there is published the Dean's List to honor students who have made a grade of "B" or better in every course taken during the previous semester.

## CLASS MEMBERSHIP

The number of semester hours credit listed below is the minimum number necessary for membership in the four classes.

Sophomore .....	32
Junior .....	64
Senior .....	96
Graduate .....	Bachelor's Degree (128)

### Admission to Upper Division

In that semester in which a student expects to complete sixty-four semester hours of credit, he shall file a written application for admission to the Upper Division of the college on a form provided by the Dean of Instruction's Office.

Favorable action on the student's request will depend upon:

1. Attaining a cumulative academic record with a semester hour-quality point ratio of 1.0 or above for his college work to date.
2. Removing from his record all incomplete grades.
3. Achieving favorable teaching personality ratings from members of the college faculty committee on selective promotion.
4. Attaining an adequate scholastic background as measured by scores on examinations as prescribed for his or her admission to the Upper Division.

Students who fail to attain the standards for admission to the Upper Division will be permitted to remain in attendance for one semester or one complete summer session after which re-application to the Upper Division must be made. The privilege of remaining in college beyond an additional semester or summer session without attaining the Upper Division will be denied except for very unusual conditions.

### Probation

A student who is deficient up to and including five quality points shall be placed on Pro-

bation. This deficiency of five quality points will include the failing of courses.

A student whose deficiency in terms of load attempted is greater than five for the first time, or a continuation from previous reviews when the deficiency was greater than five semester hours or quality points, or both, will be placed on Final Probation.

### Absence and Tardiness

Students should be familiar with the method of securing excuses for absences from class. The burden of responsibility for absence and tardiness rests at all times upon the individual involved. He must take the initiative in planning for making up work after an absence. Please note that no unexcused absence is without penalty.

1. Excused absence forms may be secured from the Dean of Men or the Dean of Women for one of the following reasons:

- a. Personal illness or emergency medical or dental appointments.

A written statement from the college nurse, the college physician, or the family doctor or dentist is required. The college nurse and doctor will require knowledge of sickness prior to time of absence in order to write such statements.

- b. Serious illness or death in the immediate family.
- c. Marriage in the immediate family.
- d. Absence from the campus for participation in athletic contests (or other college activities) when requested by the faculty sponsor and approved by the Dean of Instruction.
- e. Emergencies which the Deans of Men and Women may consider advisable. Only a very limited number of these will be granted.
- f. Limited participation in such activities

as off-campus trips, conferences, class field trips, fraternity conventions, etc., **provided the student is not on probation and has maintained a "C" in every course that semester.**

2. If the student does not secure his excuse from the Dean of Men or the Dean of Women and **present it to the instructor within seven school days after the absence, the absence shall be considered unexcused.**
3. **There is no cut system at Edinboro.**
4. Unexcused absences are regarded as likely evidence of neglect and indifference on the part of the student and may be so considered in assigning grades.
5. If a student in any course accumulates a number of unexcused absences exceeding the number of times per week the class meets, he will be automatically dropped from that course with a grade of "F". In a course meeting three times a week, for example, a student will be dropped as soon as his record shows four unexcused absences. In a course meeting twice a week, he will be dropped upon occurrence of his third unexcused absence, etc.
6. Three unexcused tardinesses shall be considered as equal to one unexcused absence.
7. All unexcused absences the day prior to and the day following vacation periods are counted as double absences.
8. It is the student's responsibility to contact his instructor to make up work missed because of an excused absence. If he does not make up this work, he will be penalized in his grade.
9. **The student may not make up work because of an unexcused absence.**
10. Whenever a student has been absent from any course more than fifteen per cent of its total class hour, the teacher in charge shall report the case to the Chairman of the Absence Committee. No student whose total unexcused and excused absences in any

course exceed fifteen per cent of its total class hours shall receive credit for that course. In individual cases, where obvious injustice would result from enforcement of this rule, the Absence Committee of the Faculty may waive it.

### Student Self-Help

There are a limited number of part-time positions available at the College, and it is anticipated that there will be a few jobs available about the community.

To be eligible for employment a student must:

1. Be matriculated as a full time student in a four-year curriculum.
2. Be boarding at the College Dining Room.
3. Be rooming on the campus unless existing facilities do not permit.
4. **Have earned an all-college average of not less than "C".**

Students desiring more information should apply at the Admissions Office.

### Loans

A small loan fund administered by the Edinboro Chapter of the Edinboro College Alumni Association is available. Consult Mrs. Ruth Peck for information about Alumni Loans.

Junior and senior men who are bona fide residents of western Pennsylvania are eligible for loans from the Student Loan Fund of the Addison H. Gibson Foundation. These loans, which carry a very low rate of interest, can be repaid after graduation. In exceptional circumstances they may also be granted to sophomores. For further information consult the Dean of Men.

### National Defense Loans

Through the cooperation of the federal

government, an amount of money is allotted for loans to outstanding students studying to be teachers. These loans are to be repaid after graduation.

Applications are available in the office of the Dean of Instruction.

### Student Advisory Program

A student advisory program provides for every student a friendly faculty member as a consultant and advisor. Thus each student as an individual will be well known by at least one college faculty member. The primary purpose of the advisory program is to assist students to attain satisfactory performance in all aspects of college activities.

The personal faculty advisor will offer the student counsel of a personal, social and academic nature to assist him to succeed in college to the limit of his ability. These advisors are concerned with habits of study, knowledge of study skills, best utilization of time in college, participation in activities.

Students receive curriculum advice and guidance from the faculty registration advisors who have charge of registration in the three curriculums. These faculty members are regarded as specialists in offering advice relating to curriculums and electives.

Students with special curriculum problems created by transfer, acceleration, failure, or for other reasons must work out their schedules with the Dean of Instruction's office.

All freshman students are assigned personal advisors. These assignments are designed to bring the student in contact with a faculty member who has similar interests and is likely to be in sympathy with his particular aspirations. Upperclassmen choose their personal advisors by calling at the office of the Dean of Instruction and filling out a form.

The ultimate aim of the advisory system is to help the student learn how to solve his own problems.

Faculty members will post their office hours outside their office doors. If you are not free at any of the times indicated, it will be necessary to make an appointment with the faculty member you wish to see. Offices and phone numbers are listed in the front of the Handbook.

### The Library

The Library is located on the second floor of Normal Hall. Throughout the school year, it will observe the following hours:

Monday through 8:00 a.m. — 5:00 p.m.

Friday 7:00 p.m. — 9:00 p.m.

Saturday 8:00 a.m. — 4:00 p.m.

The entering student at Edinboro State Teachers College soon discovers the educational and recreational facilities available in our College Library. Approximately forty-four thousand volumes offer a wide range for reference and study. A generous fiction section and 260 magazines and newspapers give the student an opportunity to fill leisure hours with enjoyable reading.

Two new periodical rooms have been opened directly behind the library. Here both bound and unbound periodicals and micro-film and microprint readers and phonographs with earphone attachments are available for the use of the faculty and students.

Our library has the distinction of being one of the few in the state which employs open shelves for all books, thus allowing all students easy access to the volumes. Of course, this system must be carefully supervised and consequently certain rules must be observed:

1. All books which have been definitely assigned to classes are placed on shelves directly behind the desk and are known as the Reserve Books. Such books may be withdrawn at 5:00 p.m. and returned at 7:00 p.m., or taken at 8:30 p.m. and returned before 9:00 a.m. the

following morning. Failure to observe this rule will result in a fine of ten cents per hour or one dollar per day.

2. Books not on reserve but in demand are termed "overnight books." These may leave the library at any time of day or overnight, but must be returned before 9:00 a.m. the following day. Penalty for late return is ten cents per day.

3. All books (with the foregoing exceptions) may be withdrawn for two weeks. A fine of two cents a day will be charged for books kept overtime. Encyclopedia volumes and dictionaries may not be taken from the Library.

4. Magazines may be withdrawn from the Library subject to the same rules as Reserve Books.

5. No student will be issued grades or credits until all library obligations have been settled.

6. No books may be removed from the library except by proper charging at the desk by the librarian in charge. Anyone taking books not properly charged from the Library will be subject to a fine of \$5.00 for each book and to suspension from all College activities until such fines are paid. Clipping and marking books is prohibited.

7. Acceptable dress in the library for both men and women is the same as for class attendance.

### Health and Infirmary Service

The college employs a full-time resident nurse and a part-time physician. Both are directly concerned with promoting good physical and mental health among college students. In addition to space for a dispensary office, an infirmary of nine beds is available for the care of minor illnesses and isolation of students with suspected communicable diseases. Surgical cases and acutely ill students other than isolation cases will be admitted only until they can

be transferred to other nearby or home hospitals. Actual medical care is limited to the prevention of illnesses and the emergency treatment of medical and surgical conditions.

Students living on campus should immediately notify the college nurse of any illness which requires infirmary care. Students living off-campus but taking meals on campus who are so ill as to require infirmary care shall immediately notify the householder and the Dean of Women or Men or the College Nurse of such illness.

When in the case of serious illness the nurse or college physician believe ambulance transportation to the infirmary or from the infirmary to a nearby home or hospital is necessary, the college will see that such transportation is provided, but the expense must be borne by the student.

Day students, who may be admitted to the infirmary provided there is space available, will pay at the rate of two dollars per day. This rate will begin with the first day.

Students will be released from the college infirmary only by a signed statement from either a responsible member of the family, the family physician, or the college physician or nurse.

Parents will be notified by the college nurse of the illness of any student who spends one or more full days in the infirmary. Any student who wishes to do so may employ his own physician at his own expense. If it is necessary to have a prescription filled at the drug store, the student will be responsible for the cost.

Accident and medical insurance on a group basis is available for all students at a minimum cost.

Off-campus and day students may avail themselves of the services of the physician and nurse.

The college infirmary will issue statements of illness to students who have received treatment in the dispensary.

Numerous requests for excuses from classes for minor and trivial illness are not in the true spirit of the college. Persistent requests for such action may be sufficient means for the administration to request a complete re-evaluation of the physical condition of the student, by his own physician, at his own expense, in order for the student to continue matriculation at this college.

### Dining Room

Meals are served to boarding students in the College dining room, located in Haven Hall.

Meal hours are:

#### WEEKDAYS

Breakfast 7:15 a.m. to 8:00 a.m.  
Lunch 11:45 a.m. to 12:45 p.m.  
Lunch (Saturday) 11:45 a.m. to 12:30 p.m.

Dinner will be served Family Style at 5:10-6:00 p.m. Monday through Friday and at 12:30 Sunday. Saturday supper is served cafeteria style at 5:00 to 5:30 p.m.

#### SUNDAYS

Breakfast 9:00 a.m. to 9:30 p.m.  
\*Dinner 12:30 p.m.  
Supper 5:30 p.m. to 6:00 p.m.  
\*Family Style

Admittance to the dining room is by identification card only. These I. D. cards are issued to all students and are non-transferable.

A limited number of guests may be accommodated in the dining room, providing individual meal tickets are purchased in advance in the office of the Director of Food Service.

Transient meal rates are:

Dinner	\$1.00
Lunch	\$ .75
Breakfast	\$ .50

### Bus Service

Edinboro is situated on the main bus line between Pittsburgh and Erie. During the day and evening the buses run, north and south, approximately every two hours. Students wishing to travel east or west can make connections in Erie, Meadville, Franklin or Pittsburgh. Since the schedules are constantly changing, schedules can be checked by calling 2481.

### Books and Supplies

Books and other supplies are obtainable at Cooper's Stationery Store. It is advisable to order your books as soon as possible after they have been designated by your instructors. Each student is expected to own the text books required in his classes.

Some supplies are on sale in the College Union. Students should check there for the exact items being sold this year.

### Mail Service

The College receives two mail deliveries each day. Dormitory mail will be delivered directly to the students' mail boxes there. Mail for commuting students is placed in the commuter's room in Normal Hall.

Lock boxes at the Edinboro post office may be secured at the rate of \$.90 a quarter.

### Boarding Facilities

All dormitory students are required to take their meals in the College Dining Room.

Off-campus students have the choice of eating in the Dining Room or of making some other provision for their meals. It is recommended and they will find it greatly to their advantage to board at the college. However, once a student has elected to take his meals in the Dining Room, he will be expected to

continue doing so for a full semester. Similarly, if he has started eating off-campus, it will not be possible for him to avail himself of Dining Room facilities until the beginning of the following semester.

### **Closing of Dormitories During Vacations**

Dormitories and the Dining Hall will be closed to all students during regular vacation periods as listed on the College Calendar, and also during the period between semesters or summer sessions.

All students will be expected to leave dormitories not later than 5:00 p.m. on the last day preceding a vacation period and should not return before 2:00 p.m. the day preceding reopening of school.

Exceptions to this rule may be granted by the Dean of Men or Dean of Women in unusual circumstances.

All undergraduate students, with the exception of Junior Aides, choir members and student employees whose services will still be needed, will be expected to leave dormitories not later than 24 hours after the last scheduled examination of the spring semester.

### **Extra-Curricular Program**

Every person who graduates from Edinboro and becomes a teacher will be expected to assume leadership in community life and school activities. In a large percentage of cases the teacher will be expected to sponsor clubs and other student groups. Therefore, it is very important that every student in college becomes accustomed to certain activities and familiar with the techniques of discussion, parliamentary law, record keeping, and the general promotion of student activities. Even if a teacher never becomes a club sponsor, the educational value of participation in these activities in college is perhaps as great as that of some course

of study. Therefore, it seems advisable that each student become a member of some club or other activity aside from athletics.

The following plan of extra-curricular activities will be in effect:

1. At the beginning of the semester each student will be given the opportunity to choose any club or activity in which he is interested.

2. A club or activity may be set up on petition of not fewer than fifteen students with the approval of the Committee on Student Activities.

3. The petitions for a new organization made to this committee should include a letter of application signed by the student leader of the organization, a list of the students who are definitely committed to membership in the organization, the names of the faculty sponsors, and three copies of the constitution and by-laws of the organization.

4. All organizations will provide for regular meetings.

5. No meeting shall be held without at least one faculty advisor present.

6. Each club or activity is to choose its own Faculty Advisor subject to the consent of the faculty member concerned and the approval of the Committee on Student Activities and of the President of the College. The Faculty Advisor is not to be responsible for planning the program of the activity since his relationship is only advisory.

7. Each activity is to have a Secretary, whose duty it shall be to record and report its membership and program to the Office of the Dean of Women.

### **Fraternity and Club Initiations**

1. Any public initiation program is to be submitted in writing for approval to the sponsor of the organization and to the Dean of Men or Dean of Women at least one week before the initiation is to begin.

2. There shall be no interruption of study



hours by initiation activities. Absolutely no initiation activities shall take place in the dormitories during quiet hours. Any actions during school hours that attract undue attention are undesirable.

3. No initiation activities shall take place in the dining hall unless express approval of the Director of Food Service and the Deans of Men and Women has been obtained.

4. The initiation program shall include no activities on campus which disturb the public in general.

5. Utmost care should be exercised to avoid bodily injury, impairment of health, personal indignity, or damage to property. Violators will be subject to penalties by the Interfraternity Grievance Committee after proper review of the situation.

6. The women's dormitories and their vicinity are strictly out of bounds for men's initiation activities. However, orderly serenading is permitted between 10:30 and 11:00 p.m. It is recommended that the pledge master of the fraternity or club call the Dean of Women to ask permission before serenading.

7. No initiation activities shall take place at a distance greater than twenty miles from the college.

### College Union

The College Union provides recreational facilities for the entire student body and faculty. A College Union Committee acts as a regulatory body.

Extensive renovation has been done to the building for this year. New equipment and new sales items have been added; the College Union also has a luncheon counter.

### Campus Automobile Regulations

1. All automobiles driven to college by students, faculty, and college employees at any time during the school year must be registered with the college.

2. All registered automobiles must display their registration stickers on the windshield in front of the rear view mirror. (This is the only location approved by the Highway Department.) Stickers may be purchased for 15 cents from the Admission Office.

3. Permission for women to maintain automobiles in Edinboro must be filed on blanks provided for that purpose by the Dean of Women.

4. All students will receive copies of the campus automobile regulations on registration day. All students are requested to follow these regulations.

5. The Dean of Men is in charge of dealing with violations; also, the local police are authorized to issue parking violation tickets to those who do not adhere to the regulations.

6. Violations of the above regulations may have automobile privileges withdrawn and in serious cases be suspended from the college. Cooperation will be appreciated.

### Daily Bulletin

To aid in the dissemination of general information of interest to all college students concerning college activities a Daily Bulletin is mimeographed and distributed throughout the college.

Items which are to appear in the Bulletin should be prepared in written form, signed by the writer, and presented not later than 2:30 p.m. of the day prior to the date they are to appear. These notices may be deposited in the "Daily Bulletin" receptacle provided for them in the President's Office in Normal Hall.

## Scheduling Social Activities

To avoid conflict it has been necessary to have one central office where all social events can be scheduled. This scheduling is done in the office of the Secretary to the College President where forms can be obtained. Requests must be submitted to the President's secretary at least two weeks prior to the date requested for the social event. They are then subject to approval by a committee composed of Mrs. Connors, the Secretary; Mrs. Peck, the Dean of Women, and Mr. Sam Cianflocco, chairman of the Faculty-Student College Union Committee.

No social event in which women are involved may be scheduled until all the necessary requirements for chaperones, hours, etc. have been met and the approval of the Dean of Women has been given. Before advertising any evening activity, it is necessary to have the activity recorded on the Social Calendar.

The scheduling Committee seeks to maintain a well-balanced and satisfactory social program. Permission for scheduling an event may be denied when the general Social Calendar or the Calendar for a particular organization seems over-crowded, or when the maintenance of high academic standards in the college would seem to discourage the activity in question.

Approval of rooms for meeting and activity purposes is administered through the Dean of Instruction's Office. Evening use of any room must be approved by the President of the College.

# STUDENT REGULATIONS

## Regulations for Women

### SECTION ONE

#### Women's Hours

##### I. Regular Permissions:

A. Regular hours shall be observed by both on campus and off campus women students according to the following schedule.

##### Monday through Thursday

Freshmen	9:00 p.m.
Sophomores	10:00 p.m.
Juniors	10:00 p.m.
Seniors	10:30 p.m.

##### All Women Students

Friday	11:00 p.m.
Saturday	12:30 a.m.
Sunday	10:00 p.m.

##### B. Late Permissions

##### Each Semester

Freshmen — Two 12:30 pers for Friday night.

Sophomores — Two 12:30 pers for Friday night. One 1:00 a.m. per for Saturday night.

Juniors — Three 12:30 pers for Friday night. Two 1:00 a.m. pers for Saturday night.

Seniors — Four 12:30 pers for Friday night. Three 1:00 a.m. pers for Saturday night.

##### II. General Provisions:

A. Whenever a woman student's name appears on the Dean of Instruction's list of students doing unsatisfactory work, i.e., work below standard, her permissions are to be curtailed or withdrawn by the Dean of women in an amount at least to correspond proportionately to the hours of work reported as unsatisfactory.

B. The Dean of Women's Office keeps a record of all permissions for each person. Women will be notified individually when their permissions have all been taken.

C. Permissions for absences from residences are granted as follows:

1. In Edinboro, all students may visit approved women's residences and business places and may attend church services and shows at the local theater.

2. Before leaving campus for overnight, a student must secure permission of her parents and of the Dean of Women except when going to her home over the weekend, for which a general permission is granted.

3. A student may spend Friday and Saturday nights in a room other than her own providing she registers her intention in writing with the Dean of Women.

### SECTION TWO

#### Guests

##### I. Men Students in Women's Residences:

A. Men students must not loiter in women's dormitories from 8:30 a.m. to 11:30 a.m. and from 1:00 p.m. to 4:00 p.m.

1. Men students visiting women residents may stay in the visitors lounges in accordance with the women's hourly regulations.

B. Men and women guests must always conduct themselves in accordance with accepted standards of ethics. Violations of such standards will result in woman's loss of privileges.

### SECTION THREE

#### Women's Dormitory Council

The Women's Dormitory Council acts as the advisory body for enforcing the regulations concerning the women and planning social functions. The Council consists of a president, vice-president, social chairman, secretary, treasurer, fire captain from each dormitory, and a Student Council representative from each dormitory; all of these officers are elected by and

from the entire body of women resident students.

Meeting time: 2nd and 4th Thursday, 6:30-7:30 p.m.

#### SECTION FOUR

##### Locking of Doors

All doors are locked at 10:00 o'clock by the night watchman, except Friday and Saturday nights when they will be locked at 11:00 p.m. and 12:30 a.m. respectively. Women students having late permissions will be admitted at the time for which their permission has been granted.

#### SECTION FIVE

##### Parents' Permission

Written permissions for women students by parents are required for:

- (1) going home weekends
- (2) swimming
- (3) canoeing and boating
- (4) skating
- (5) riding in automobiles
- (6) visiting away from home or college.

Such requests are subject to final approval by the Dean of Women.

Forms will be sent to parents for recording their requests.

Because of the danger of accidents, permissions of parents must be granted before students may ride in automobiles. During the day all students may ride within the borough limits if their parents' permission is in the Dean's office, but after 6:00 p.m. students must have the additional permission of the Dean of Women. **Special permission from the Dean of Women must be obtained for all trips outside the borough of Edinboro.**

A woman student is not permitted to leave for home after an evening college function of any kind except by special written permission from her parents, which must be in the Dean of Women's office two days before the event.

#### SECTION SIX

##### Dormitory Maintenance Problems

###### 1. Rooms

Assignment to rooms is made by the Dean of Women or her agent. Keys are procured from the Office of the Bursar. Rooms must be kept clean and ready for inspection at all times. Tacks, scotch tape or nails in walls are not permitted. The electric wiring is not the type for heating appliances; therefore, electric irons and hot plates are not permitted.

Damage to furnishings or walls will result in a fine being charged against the offender. The minimum charge will be one dollar, to be paid to the College Bursar.

###### 2. Smoking

Fire regulations and the protection of life and property require that students do not smoke in their rooms or elsewhere in the college buildings except where special provisions are made by the College. Failure to comply with this regulation may cause suspension or dismissal from the college.

###### 3. Telephone

All residents of Haven Hall must become familiar with the campus telephone system and be ready and willing to answer the Haven Hall desk phone at all times.

###### 4. Absence from Campus

Before leaving the campus for an absence of more than one hour, and after 5:30 p.m., a student is required to register her name, destination, and expected time of return on the forms provided at the desks in their campus residence, and, upon returning, the time of her return.

###### 5. Quiet

Evening quiet hours are desirable and arranged by House action. Night quiet hours, except Saturday, are from 7:00 p.m. to 10:30 p.m., 11:00 p.m. to 7:00 a.m. Saturday; midnight to 9:00 a.m. Sunday. Pianos must not be played during these hours. Radios may be

played at any time except during the night quiet hours, provided that they are tuned so they cannot be heard outside the room.

#### 6. Callers and Guests

(a) Guests for overnight or for the dining room should be introduced upon arrival to the Dean of Women. Students may have overnight guests in the dormitory only over weekends, except in very special cases if space is available. Arrangements for linen must be made before the guest arrives.

It is understood that guests will follow the regulations governing their hostess and that the responsibility for acquainting guests with these regulations rests with the hostess.

Overnight guests must register on cards provided by the Dean of Women. Charge for overnight lodging is one dollar per person.

(b) Fathers and other masculine guests of women students must be entertained in the dormitory lobby unless by special permission they accompany a woman student to her room. This does not apply to the first day of the college year.

(c) The hall is closed to guests at 10:00 p.m. daily, 11:00 p.m. Friday, and 12:30 a Saturday.

(d) On the evening of all college functions, such as lectures, games, movies, etc., which last beyond the hours listed in A, all students must report in not later than one-half hour after the close of the function.

#### 7. The Recreation Rooms

These rooms are located in the basements of both women's dormitories and provide women students with facilities for social and recreational activities.

#### 8. Off-Campus Regulations

All students living outside the dormitories must have the approval of the President for such residence unless they are living in their own homes.

The Housing Committee has a list of the residences which have been officially desig-

nated as Approved Houses. Permission to live in these homes is not automatically granted. However, as in the case of any other off-campus arrangement, individual arrangements are only temporary until the application blanks are received, approved, and filed by the Housing Committee.

Women students living in Edinboro in homes other than their own are expected to follow, in general, the rules applying to residents on campus. Permission ordinarily granted by the Women's Dormitory Council may be granted by the house mother.

#### 9. Drinking

No alcoholic beverages may be brought on the campus. Persons who violate this regulation are subject to the severest disciplinary measure.

Any woman who returns to the campus under the influence of liquor will be summarily suspended.

### Regulations for Men Students

Men's regulations are controlled by the Men's Council, the Dean of Men, and the President of the College. The Council consists of four representatives from Reeder Hall, one each from the State Houses Annexes, and one from the off-campus men.

It is primarily insisted that all men conduct themselves as gentlemen and in keeping with the accepted standards of good taste.

1. Men are expected to dress appropriately for all occasions. Even for the most informal and casual occasions, clothing shall be clean and neat.

(a) Jeans, levis, sweat shirts and T-shirts are not considered appropriate for the dining room, and men so attired will be refused admission.

(b) For the evening meal men will wear shirts and a sack coat, or a sport jacket.

- (c) Students visiting the Training School should dress as future teachers. Men will, therefore, wear suits and ties.
- All men are expected to be cooperative in respect to the women's regulations. They are requested not to loiter in women's dormitories during the following hours: between the hours of 8:30 to 11:30 a.m. and 1:00 to 4:00 p.m.. Women's male guests are expected to be suitably dressed.
  - After 10:00 p.m. the vicinity of the seven women's residences on Meadville Street is strictly out of bounds for men students. Men who are escorting residents of these houses may accompany the young lady to the door of the house after this hour, but must then leave immediately.
  - No alcoholic beverages may be brought on the campus.** Persons who violate this regulation are subject to the severest disciplinary measures.
  - Any man who returns to the campus under the influence of liquor will be summarily suspended.**
  - Any man who conducts himself in public, on or off the campus, in a way that reflects on the college is subject to disciplinary action.
  - Dormitory evening quiet hours are from 8:00 to 10:00 p.m. Night quiet hours are from 10:30 p.m. to 7:00 a.m. On Saturdays, however, quiet hours begin at midnight extend to 9:00 a.m. Sunday. During quiet hours men are expected to enter and leave the building making the least noise possible. **Hall monitors will see that this rule is enforced.**
  - No musical instruments are to be played in the dormitories at any time. Radios, phonographs and tape recorders may be played in the room provided room-mates do not object, but volume must be kept low enough to prevent the instrument from being heard outside the room. **Men who**

- show lack of consideration for others in this respect may be prohibited by the head resident from playing their machines at all.
- Men may have overnight-guests providing facilities are available and the approval of the Dean of Men has been obtained. Guests must be registered. The transient lodging fee of one dollar will be collected.
  - All men are expected to cooperate in keeping halls and washrooms clean and in order. Bottles are to be returned to the Coca-Cola dispensing machine. Paper and refuse are to be put in trash cans. After using a lavatory, every man is expected to wipe it out and leave it in the condition in which he would like to find it if he were the next to use it.
  - Each man is responsible for the tidiness of his own room. **Periodic inspections will be made and men found to be consistently negligent will be asked to move to off-campus quarters.**
  - Because of fire hazards, the use of electrical appliances other than dry-shavers and radios cannot be permitted in dormitory rooms. Special outlets for use of electric irons will be found in the basement of Reeder Hall and in the lower corridor at White Hall.
  - Men who smoke must provide themselves with metal or ceramic ash trays.
  - Food may not be kept in dormitory rooms unless stored in metal boxes. Keeping bottles on window sills is not permitted.
  - Every dormitory resident is expected to have a key to his room. **Rooms should be kept locked whenever residents are out.** Keys are to be obtained from the Office of the Bursar.
  - Any man having a grade of less than "C" in any subject will be expected to be in his room studying, Monday through Friday, during evening quiet hours.**

17. The counselors assigned to the annexes represent the Dean of Men, and all annex residents are expected to give them their cooperation.
18. A fire monitor on each floor of Reeder Hall will make sure that every man obeys the fire rules during a fire drill.

### Regulations for Off-Campus Students

1. Students living off-campus are not segregated in any way from those living on campus. They do, however, have representatives in the Student Council who help advise and settle problems pertaining to the off-campus group. Rules applying to students living in the college dormitory apply equally to those outside the dormitory.
2. A day-room is provided for off-campus men in the basement of Normal Hall. Here they may study, relax, and eat their lunches. The students using this room are expected to keep it free from litter and refrain from conduct that might prove disturbing to others.
3. Lockers for day students are available in the basement of Normal Hall. Keys may be obtained from the Office of the Bursar.
4. Students rooming off-campus are expected to show consideration for and to cooperate with the people in whose homes they are guests. Particularly they should be as quiet as possible if they enter late or stay up after the other inmates of the house have retired. They should introduce no guests without the householder's express permission. They should be careful not to leave lights on, water running, doors or windows needlessly open. They should not turn on the householders television or radio set unless invited to do so. They should not abuse telephone privileges and should be prompt in making payment for long distance calls. They should cooperate in keeping their rooms clean and

- in order. They should not expect kitchen privileges.
5. All women who are not living in the dormitories may study or relax in the students' day-room, located in the basement of Normal Hall, whenever they do not have a class during the day. This room is open daily from 7:30 a.m. to 6:00 p.m. and Saturdays from 7:30 a.m. to 12:00 noon.

The parlors of Haven Hall are open to all women students. Also available for use is the Social Room in the basement of Haven Hall, which is open during the regular dormitory hours.

### Dormitory Fire Regulations

Fire drills are held at least once a month. All girls must participate, and greatest care must be taken to see that everyone follows orders implicitly. The object is to get all girls out of the hall safely. Speed is imperative. Silence is necessary.

### FIRE DRILL PROCEDURE:

- I. When fire alarm rings:
  1. Close the windows.
  2. Turn on the lights.
  3. Put on a long heavy coat.
  4. Put on shoes.
  5. Have a towel in one hand.
  6. Stand outside closed door or room until captain gives signal to start.
- II. When Captain gives signal to start, observe the following rules:
  1. Walk down corridor on own side to the nearest fire escape or exit (as ordered by fire captain).
  2. Residents of each floor will wait until residents of floors above have vacated. This prevents congestion on the stairway.
- III. Miscellaneous:

UNIVERSITY OF CALIFORNIA

STUDENT GOVERNMENT

STUDENT GOVERNMENT

STUDENT GOVERNMENT

# STUDENT GOVERNMENT AND CONSTITUTION

STUDENT GOVERNMENT

STUDENT GOVERNMENT

STUDENT GOVERNMENT

STUDENT GOVERNMENT

STUDENT GOVERNMENT



## STUDENT GOVERNMENT

### Student - Faculty Council

President ..... Larry Moses  
Vice President ..... Joe Lanberty  
Secretary ..... Pat Gray

The Student-Faculty Council considers and enacts much legislation in connection with campus problems. An important function is the budgeting of the Student - Activity Fund. The Council meets regularly and is always ready to listen to and discuss any new proposal for college progress. Council meetings are open to any of the student body who wish to attend.

Council members are elected by the student body and faculty and serve for two semesters. Membership in this group is considered a very high honor.

### Constitution

Revised 1948, 1954 and 1958

#### ARTICLE I

##### NAME

The name of this organization shall be the Student-Faculty Co-operative Government of the Edinbro State Teachers College.

## ARTICLE II

### PURPOSE

While appreciating deeply the province and functions of the other administrative bodies, we the students, the faculty, and the President of the College, feel that there still remains unoccupied a large promising field for cooperative service. Accordingly, we do hereby declare that the purpose of the Co-operative Government is to take over increasingly the responsibility for organizing and directing purely student affairs, to co-operate with the proper college authorities in matters of student welfare, and to seek constantly to make the college a better agency for developing effective citizens and teachers.

## ARTICLE III

### MEMBERSHIP

The membership of this Co-operative Government shall consist of all students, all faculty members, and the President of the College.

## ARTICLE IV

### FUNCTION

All student and student-faculty organizations are subject to the council and to the approval of the President of the College.

## ARTICLE V

### MEMBERSHIP, ELECTION, OFFICERS OF THE COUNCIL

Section 1. The Student Faculty-Council shall be composed of the following:

- (a) One representative for each 150 women on campus, or a fraction of 1/3 or more thereof, apportioned among the dormitories by the Women's Dormitory Council but in such a manner that if possible each dormitory of 50 persons or more will have at least one representative.
- (b) One representative for each 150 men on campus, or a fraction of 1/3 or more thereof, apportioned among the dormitories by the Men's Dormitory Council but in such a manner that if possible each dormitory of 50 persons or more will have at least one representative.
- (c) One representative for each 150 off-campus men, or a fraction of 1/3 or more, thereof.
- (d) One representative for each 150 off-campus women, or a fraction of 1/3 or more, thereof.

- (e) Two representatives from each class, one man and one woman, selected by the classes.
- (f) A faculty member elected annually by the faculty.
- (g) A faculty member appointed by the President of the College.
- (h) The Dean of Men and the Dean of Women.

Section 2. Methods of election:

To be eligible for election to the Council, students should be outstanding in character and ability and have a college record of better than a "C" average.

At the beginning of the first semester of the freshman year, a man and woman representative shall be elected. The woman will serve two semesters, the man will serve one semester, and in his place for second semester, a new male representative will be elected to serve for two semesters.

The following method shall be used to elect class representatives:

Each class will elect two members, one male, one female, to the Student Council. The upper three class representatives will have been elected by October 1; the freshman by the end of the first quarter, and for the second semester elections, by February 15.

Other groups shall elect their representatives by popular vote prior to October 1.

The president shall be elected in the following manner:

Two weeks after the opening of the second quarter of the first semester the president of the junior class shall appoint a nominating committee of three who shall nominate at least two persons from the junior class as candidates for the office of President of the Council. In addition any junior may be eligible for this office if a petition signed by twenty-five students requesting that his name be placed on the ballot, be presented to the secretary of the Council, at least forty-eight hours before the election. At an assembly not later than December 5, each candidate will speak about his aims or plans regarding the Student-Faculty Co-operative Government. One week following the speeches, no later than December 12, the students shall elect the president of the Council by ballot. The president-elect shall then attend all meetings as a non-voting member until his term of office begins with the first regular meeting of the Council after second semester begins. The former president may attend all meetings as a non-voting member of the Council for the duration of the second semester.

Section 3. Any student vacancy on the Council shall be filled for the balance of his term at a special election conducted in the same manner as herein prescribed for the regular election.

Section 4. The other officers of the Council,

which shall be vice-chairman and a secretary, shall be chosen annually by the Council from its student members immediately after the new president has taken office.

## ARTICLE VI

### DUTIES OF THE COUNCIL

Section 1. To initiate, organize, and direct, in co-operation with the faculty, a social program for the entire student body.

Section 2. To integrate, improve, and supervise the organization and activities of all students and student-faculty groups.

Section 3. To act upon submitted requests for the organization of any new student or student-faculty group.

Section 4. To provide, as needed, cooperative standing committees such as the following: Budget Committee, Assembly Committee, Student Union Committee, Freshman Orientation Committee Social Committee, Handbook and Publicity Committee. Also, any temporary committees deemed necessary. These committees may co-operate with purely faculty committees for the same purpose and shall have at least three members (student and faculty). Student members to these committees shall be appointed by the President of the Council with the approval of the Council and the approval of the President of the College. Faculty members of these committees shall be appointed by the President of the College.

Section 5. To co-operate with the College President, the Trustees, or some properly delegated authority in the assessment, collection, and control of any student Activity Fee or other fees, or dues that the students, upon the recommendation of the Council, may agree by majority vote to assess or pay to provide for activities, agencies and welfare not adequately supported by the State provided that the said fees or dues are approved by the President of the College and Board of Trustees, or other controlling agency.

Section 6. To hold two regular meetings a month, the first and third Wednesdays of each month, unless otherwise stated by the council, in addition to special meetings as needed. A quorum shall constitute a majority of the elected members.

Section 7. To recommend to the faculty or the President of the College penalties for specific disciplinary cases which are not sufficiently serious to warrant possible expulsion or other severe punishment.

Section 8. To provide for at least one general study assembly each semester for the purpose of interpreting the work of the Council and for transacting any business of general interest to the Student Body brought before it by the Council,

the College President, or a representative of the students or the faculty.

## ARTICLE VII

### POWERS OF THE PRESIDENT OF THE COLLEGE

Because of the nature of the office of the President of the College and his responsibilities to the Board of Trustees, the State Superintendent of Public Instruction, the State Council of Education, and the Governor, the President is an ex-officio member of all committees and to him is reserved the duty and right of final approval of all acts, rules and regulations that may be devised or offered.

## ARTICLE VIII

### FINANCES

Section 1. In order to co-ordinate and control the funds of the several student-faculty activities and organizations under the control of the Budget Committee of the Student Council all funds belonging to or collected by these organizations shall be deposited upon request of the Council in and disbursed through a general fund of which a faculty member (or members) shall be treasurer. This treasurer (or treasurers) is to be appointed by the President of the College.

Section 2. The delegated custodian shall keep individual and separate accounts of the funds and credits of each organization. Disbursements shall be made only upon duly authorized requisition of each organization.

Section 3. There shall be an annual audit of the General Control Fund. This audit shall be published or posted within two weeks after the audit is completed.

Section 4. To prepare and submit to the faculty, the President, and student body by May 1, a tentative budget for the succeeding school year of the disbursement of Student Activity Funds; and to prepare and submit to students, faculty, and the President by October 1, a final budget for the disbursement of Student Activity Funds. This duty is to be performed by a committee, known as the Budget Committee to consist of at least three students and two faculty members appointed by the President of the Student Council and the President of the College.

## ARTICLE IX

### RATIFICATION AND AMENDMENTS

Section 1. This Constitution shall go into effect as soon as ratified by the approval of the

President of the College and by a two-thirds vote of those present at the meeting for this purpose.

Section 2. This Constitution may be amended or revised by a majority vote of the entire student body and the faculty provided that said amendments or revision first be submitted in writing to the Council and the President of the College, approved by them, and then posted for two weeks.

# STUDENT ORGANIZATIONS

## ACTIVITY SCHEDULE

Organization	Time	Place
Student P.S.E.A.	1st Tuesday of month 7:00 p.m.	New Dorm. Basement
Alpha Phi Omega	1-3 Wednesday of month 9:00 p.m.	Interfraternity Room
Alpha Psi Omega		
English Club	1st Friday of month	
Geography Club	2-4 Tuesday of month 7:00 p.m.	NH-1
Photography Club	Every Tuesday 3:45 p.m.	NH-5
Physical Science Club	2-4 Wednesday of month 7:30 p.m.	L-11
Social Studies Club		
Kappa Delta Pi	3rd Friday of month	
Mu Kappa Gamma	2-4 Tuesday of month 8:30 p.m.	Blue Room
Delta Phi Delta	1-3 Tuesday of month 8:15 p.m.	L-2
Beta Beta Beta	3 Wednesday of month 7:00 p.m.	
Conneauttean	Every Friday 3:45 p.m.	
Spectator Student Handbook		
College Band		
Collegiate Singers	Every Monday & Wednesday 3:20 p.m.	Auditorium
Collegiate Players	Every Tuesday 7:00 p.m.	Auditorium
Inter-Fraternity Council	1-3 Thursday of month 4:15 p.m.	Interfraternity Room

# MAP OF CAMPUS

## Key

1. Normal Hall
2. Music Hall
3. Compton School
4. State House

5. Recitation Hall
6. Memorial Auditorium
7. White Hall
8. Women's New Dorm.

9. Haven Hall
10. Loveland Hall
11. East Hall
12. College Union
13. Crawford Gymnasium
14. Power House
15. Reeder Hall
16. Conneauttee House
17. Cussewago House
18. Kinzua House
19. LeBoeuf House
20. Mead House
21. Tionesta House
22. Venango House

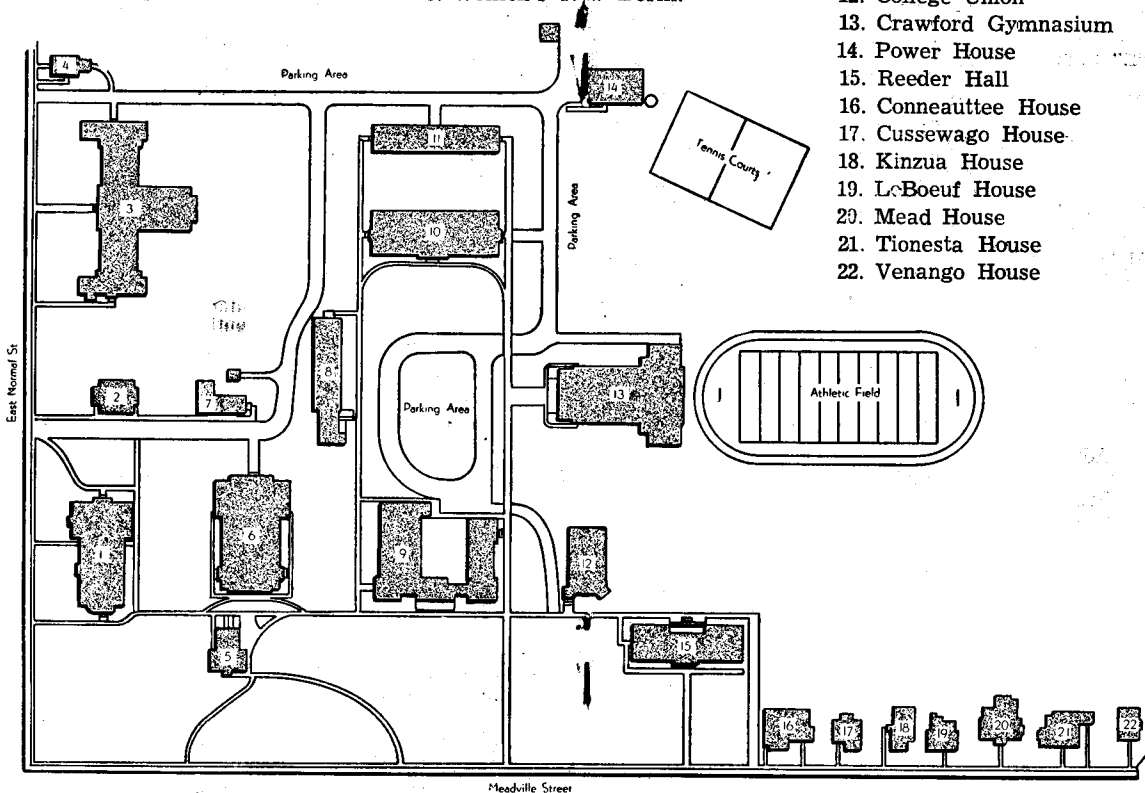

Alpha Delta	1-3 Monday of month 8:30 p.m.	Interfraternity Room
Delta Sigma Phi	Every Thursday 9:00 p.m.	Interfraternity Room
Phi Sigma Pi	2-4 Monday of month 10:00 p.m.	Interfraternity Room
Kappa Delta Phi	1-3 Monday of month 10:00 p.m.	Interfraternity Room
Zeta Tau	1-3 Wednesday of month 8:30 p.m.	Interfraternity Room
"E" Club	Every Tuesday 10:00 p.m.	Reeder Hall T.V. Room
Kiltie Fins	Every Wednesday 7:00 p.m.	Gymnasium
Pep Club	Every Monday 7:00 p.m.	Gymnasium
Red Cross Intercollegiate Council	3rd Tuesday of month 8:00 p.m.	L-13
Sigma Tau Gamma	Every Monday 8:15 p.m.	NH-3
Alpha Gamma Delta	2-4 Monday of month 7:00 p.m.	Interfraternity Room

NOTE — Any changes of place or any special meetings must be authorized through the President's Office.

## STUDENT PROFESSIONAL ORGANIZATIONS

### STUDENT P.S.E.A.

Advisers	.....	Mrs. Helen Nicely and Dr. Ernest LaFollette
President	.....	Bernard Sauers
Secretary	.....	Janet Wilcox

The PSEA is a branch of the NEA. It was established in 1937, and since then over four hundred college chapters have been established in forty-six states.

The purposes of the PSEA are: to give students closer contact with the field of education; to cultivate leadership, personality, and character; to provide future teachers with information about opportunities in various fields of education; to develop greater unity among teachers and future teachers; and to foster interest among future teachers concerning the

role of free public education in a democracy. The PSEA is open to all students and each member is automatically affiliated with both the PSEA and NEA and receives literature from both. The membership fee is \$2.00 per year.

There are many committees (permanent) in the PSEA, and each member belongs to at least one of these — teaching, campus-tour-service, exhibit service and production of visual aids. The club also publishes a Newsletter for the Northwestern District of the PSEA.

### Alpha Phi Omega

Advisers	.....	Dr. John T. Gatzky
President	.....	Dennis Condon

Alpha Phi Omega is a national service fraternity whose purpose is to assemble college men in the fellowship of the Scout Oath and Law, to develop friendship, and to promote service to humanity. There are over 280 chapters of Alpha Phi Omega in colleges and universities of the United States. To be eligible for membership a man must be or have been affiliated with the Boy Scouts of America. Meetings: 1st and 3rd Wednesday, 9:00-10:30 p. m.

### Alpha Psi Omega

Advisers	.....	Miss Jane Ludgate, and Mr. Lawrence Vincent
President	.....	Lee Johnson
Secretary	.....	Patricia Gray

In 1930 Gamma Kappa Cast of Alpha Psi Omega, national honorary dramatic fraternity, was established on this campus. Its motto is: "Seek a life useful." The membership is composed of men and women students whose work in one or more fields of dramatic art is either outstanding or unusually fine. Eligibility requirements include scholastic standing and

faithfulness shown in attending all rehearsals of actors or meetings of work crews. The honor of pledging and initiation is presented once a year.

### The English Club

President, ..... Carol Hogan  
 Vice-President, ..... Cynthia Clement  
 Sec.-Treas., ..... Patricia Gurgurich

The English Club has no restrictions for membership other than a willingness to participate in activities furthering the appreciation of Language and Literature and the Teaching of English. On several occasions each year, members meet in faculty homes. They also attend off-campus functions which are of interest to English students.

### Geography Club

Adviser ..... Dr. Harriet R. Long  
 President ..... Donald Laughner  
 Secretary ..... Reid Miller

The Geography Club provides the opportunity for students especially interested in geography to associate with persons of like interests.

Meetings are the second and fourth Tuesdays of each month in Recitation Hall at 7 p.m.

### Photography Club

Adviser ..... Dr. Ernest LaFollette  
 President ..... Paul O'Hara  
 Secretary ..... Sharon Owens

Students interested in camera work will find interesting activity in the Photography Club. This group meets once a week and makes use of excellent darkroom facilities provided by the College in the basement of Normal Hall. Membership in the club is limited to twelve by selecting those who attend meetings regular-

ly. Darkroom space and privileges are extended to students who participate. Special help is given to beginners as well as those more advanced.

Meeting time: Tuesday, 3:45 — 5:00 p.m.

### Physical Science Club

Advisers ..... Mr. James P. Coffman  
 ..... and Mr. Thomas Come  
 President ..... John Sechrist  
 Vice President ..... Dennis Luce

The Physical Science Club is an organization which creates an interest in science and demonstrates its importance as a benefit to our society. Full membership is open to all science majors and minors. Associate membership is open to all other members of the college.

The Club offers various social functions such as: lectures by well-known speakers, field trips to places of interest, and assemblies in the field of science, and scientific displays. The club develops these activities to their fullest capacity and provides an active and interesting program to every member.

Meetings are held the second and fourth Wednesday of each month in Loveland Hall at 7:30 p.m.

### Social Studies Club

Advisers ..... Dr. D. T. Thompson  
 ..... Mr. C. Wozniak and Dr. A. Shuster  
 President ..... Bill Sabo  
 Secretary ..... Lea Carlson

The Social Studies Club offers the opportunity for students especially interested in the social sciences to pursue their interests in cooperation with their colleagues. The club meetings are devoted to a discussion of current social, economic, and political problems. Members of the organization prepare panel discussions for club meetings and frequently employ

speakers to bring them expert knowledge. The Social Studies Club also conducts mock elections for the student body, presents assembly programs, and organizes trips to such professional meetings as the National Council for the Social Studies, the Pennsylvania Council for the Social Studies, and other organizations.

### Kappa Delta Pi

Advisers . . . . . Miss Frances Whitney

Kappa Delta Pi, national honor society in education, has as its purpose, "to encourage high professional, intellectual, and personal standards and to recognize outstanding contributions to education."

To be eligible for membership in this organization a student must have a high scholastic rating, a pleasing personality, and leadership ability. Only students who have at least a "B" average in education subjects are considered.

Meeting time: third Friday, 7:00-8:30 p.m.

### Mu Kappa Gamma

Adviser . . . . . Mrs. Esther Campbell  
 President . . . . . Marlene Gamer  
 Vice-President . . . . . Elaine Morton  
 Sec. - Treasurer . . . . . Carol Irwin

Mu Kappa Gamma, honorary music society, limits its membership to those students who have contributed to the musical life of the campus in some outstanding way. Leadership, scholarship, musical ability, length of service and cooperation are other points upon which membership is based.

The organization sponsors trips to concerts and operas besides arranging for the appearance of various outside musical organizations on the campus. Meeting time: 2nd and 4th Tuesday, 8:30 — 10:00 p.m.

### Delta Phi Delta

Adviser . . . . . Mr. Richard Mower  
 President . . . . . Bev. Moore  
 Secretary . . . . . Barbara Robison

Delta Phi Delta is a national honorary art fraternity, open to men and women who are students of art in our American universities, colleges, and art schools. Exceptional ability in art and high scholastic standing are the basic requirements for membership. The aims of the fraternity are: to stimulate higher scholarship, to recognize potential professional ability, and to develop professional art interests.

The Chi Chapter at Edinboro, among other activities, performs many art services for the College and students.

Meeting time: first and third Tuesday, 3:15-4:30 p.m.

### Beta Beta Beta

Advisers . . . . . Dr. John T. Gatzy  
 President . . . . . Anthony Bianchi  
 Vice - President . . . . . Andrew Gall  
 Secretary . . . . . Raymond Catalano  
 Historian . . . . . Clair Wimer

The chapter Alpha Chi of Beta Beta Beta, the National Biological Honor Society, was established on this campus in 1950. It serves a threefold purpose: stimulation of sound scholarship, dissemination of scientific knowledge and promotion of biological research.

To qualify for membership in this fraternity, a student must obtain an average of "B" or better in all of his biological courses and rate above average in all other courses.

Monthly meetings are held to discuss some important biological topic. Also the fraternity sponsors many important biological projects. Meeting time: 3rd Wednesday, 7:00 — 8:30 p.m.



## STUDENT PUBLICATIONS

### The Conneautteean

Art Adviser	...	Mr. A. H. Doucette
Business Adviser		Mr. Carl Wozniak
Photography Adviser	Dr. Ernest LaFollette	
Literary Adviser		Mrs. Ruth Harris
Editor		Linda Hathaway
Business Manager		Edward Newton

The Conneautteean, the college yearbook, is a student enterprise. Published by the Junior Class, the book offers valuable experience to all students interested in various phases of journalism.

The name "Conneautteean" is derived from the original name of Edinboro Lake — Lake Conneauttee.

Distributed without charge to students.  
Meeting time: Friday, 3:45 - 5:00 p.m.

### The Spectator

Adviser	...	Mr. George Bond
Editor	.....	Diane Stone
Business Manager	.....	Rita Mazur

The Spectator, campus newspaper, has had a traditional reputation for good journalism at Edinboro. Published periodically by a staff of students, the Spectator covers all phases of college life. It offers an excellent opportunity for freshmen as well as upperclassmen to gain experience in newspaper work. Cost of the publication is covered by the Student Activity Fund and advertising. The Spectator is distributed without extra charge.

### The Student Handbook

Adviser	.....	Mr. William Cornell
Editor	.....	Elliott Winograd

The Handbook is published each summer as an aid to students in better understanding the college and to serve as a reference for all those wishing to find facts relating to the college, its facilities, the faculty, and activities.

A committee chosen by the Student Council is responsible for publishing the Handbooks which are distributed to all students at registration.

### The College Band

The college band is a concert and marching organization open to all qualified students.

The marching band plays for all home football games and travels to one out of town game each season. The marching band also participates in the annual Homecoming parade, and small groups from the band frequently appear at pep rallies and similar affairs.

The concert band presents a concert during the Christmas season, and another in the spring. During the second semester the concert band also makes a trip, appearing at high schools, colleges, or charitable institutions.

The college owns a number of the larger and more expensive instruments which are available for student use.

Recognition of band participation is accorded through a system of awards based upon attendance and general value to the band. Opportunity to join is offered the first week of school to all students who play reasonably well.

Meeting time: Tuesday and Friday 3:20 - 5:00 p.m.

Monday 6:30 - 8:00 p.m.

Officers	
President	..... Jon Shallop
Vice-President	..... Thomas Ainsioagh
Secretary	..... Elaine Morton
Director	..... Dr. Glen C. Law

## Collegiate Singers

Director ..... Mrs. Esther Campbell  
President ..... Carol Irwin  
Secretary ..... Pat Meerdinck

The Collegiate Singers are a very active organization giving a Christmas Vesper Service the Sunday before Christmas vacation and a Spring concert the first week in May. The members provide music for Baccalaureate and Commencement programs, College and High School assemblies, teas, civic and social clubs. Membership is determined by tryouts held the first week of school, and all students who like to sing are urged to participate.

Meeting time: Monday and Wednesday,  
3:20 - 5:00 p.m.

## DRAMATICS

### Collegiate Players

Adviser ..... Mr. L. C. Vincent  
President ..... Rita Balbo

This organization is available to all students who are interested in developing their dramatic abilities. The club aims to give people creative experience which will aid them in their teaching careers, to serve the college, to further an interest in the drama, and to develop the members' artistic ability through the study and production of plays.

Meeting time: Tuesday, 7:00 - 8:30 p.m.

Rehearsal schedule for Julius Caesar: Mon.  
Wed., Fri., 7:00 - 10:00 p.m., September 16, -  
November 11.

Rehearsal schedule for South Pacific: Mon.,  
Wed., Fri., 7:00 - 10:00 p.m., February 1 to  
April 6.

and

## GREEK ORGANIZATIONS

### Inter-Fraternity Council

Adviser .... James P. Coffman  
President .... Stanley Zimmerman  
Secretary ..... Jo Rossi

The purpose of this organization is to provide and maintain good relationships among the member fraternal organizations of the Inter-Fraternity Council.

Membership to this organization is open to any member of a campus sorority or fraternity which is approved by the President of the College.

Meetings: Inter-Frat Room, 1st and 3rd  
Thursday each month at 4:15 p.m.

### Alpha Delta

Adviser ..... Miss Mildred Forness

The Alpha Delta Sorority was founded in 1886 in Brockport, New York, and the Iota Chapter was installed at Edinboro in 1927. It has sister chapters in seven State Teachers Colleges of Pennsylvania and New York.

The requirements for membership are based on scholastic ratings, character, social attainments and abilities. The purpose of the sorority is to foster the development of all these traits toward the achievement of a socially integrated personality. Meeting time: 1st and 3rd Monday, 8:30 - 10:00 p.m.

### Delta Sigma Phi

President .... Hal Spencer  
Vice President .... Richard Heasley

Delta Nu Chapter of Delta Sigma Phi fraternity was organized on the Edinboro campus in February, 1957, as the Delta Sigma Tau club. Formal installation as a chapter of Delta Sigma Phi International took place in January, 1959. The international fraternity has chapters in more than one hundred colleges in

the United States and Canada.

Delta Sigma Phi is a social fraternity placing great emphasis upon scholarship and leadership.

Meeting time: Thursday 9:00 - 10:00 p.m.

### Phi Sigma Pi

Advisers     ...     Mr. H. W. McNees  
                           Mr. Ralph D. Bruce  
                           Mr. Richard Mower  
President     .....     Joe Lamberti  
Secretary    .....     George Vurgich

The Phi Sigma Pi fraternity was founded in 1916 in Washington, D. C., and the Upsilon chapter was installed on this campus in 1938. It is a member of the National Interfraternity Council, an organization of nine leading professions, and is in itself a national professional educational fraternity.

The basic requirements for membership in Phi Sigma Pi are scholarship, leadership, and social aptitude. This fraternity emphasizes the professional development of teachers and promotes the spirit of scholarship, brotherhood, and loyalty. Some of the activities of the Upsilon Chapter here at Edinboro College are: dances, hayrides, skating parties, picnics, banquets, and professional meetings.

Meeting time: 2nd and 4th Monday, 10:00 p.m.

### Kappa Delta Phi

Advisers     .....     Mr. James Coffman  
                           and Mr. Carl Wozniak  
President     .....     Robert Zanotti  
Secretary    .....     Aubrey Dillon

Kappa Delta Phi is a national professional educational and social fraternity with chapters in many leading eastern teachers colleges. The purpose of our fraternity is to strengthen and preserve the bonds of fellowship which would

unit men working for a common cause.

Some of the activities sponsored by this organization are: dances, hayrides, banquets, wiener roasts and picnics. The trip to Boston for the Kappa Delta Phi National Convention is also a yearly occurrence.

Meeting time: 1st and 3rd Monday, 10:00 - 10:30 p.m.

### Rho Sigma Chi

Advisers     .....     Dr. Alice Shuster  
Mrs. George Bond and Miss Jane Ludgate  
President     .....     Amalia Person  
Secretary    .....     Sharon Owens

Rho Sigma Chi was organized on the campus in the spring of 1959. Its requirements for membership are based on scholastic ability, character, and personality. The aims of the organization are to foster scholarship, initiative, and loyalty, and to provide services to the

Meeting time: 1st and 3rd Wednesday of every month.

college and community and social activities for the members.

Meeting time: 1st and 3rd Tuesdays at 7:00 - 8:30 p.m.

### Zeta Tau

Advisers     .....     Dr. Harriet Long  
                           and Mrs. William Cornell  
President     .....     Judy Drake  
Secretary    .....     Virginia Stankus

Zeta Tau Sorority was organized on this campus in September 1958. Zeta Tau is a service and social sorority. Requirements for membership are based on scholastic standing and character.

Meeting time: 1st and 2nd Wednesday of every month.

## Sigma Tau Sigma

Advisers ..... Mr. Curfis L. Ickes  
and Mr. Charles H. Glendinning  
President ..... Ralph Spaulding  
Secretary ..... Wayne Skinner

The Sigma Tau Sigma Club was organized on the campus in December, 1958. It plans to become affiliated with the Sigma Tau Gamma Fraternity early in January.

The national fraternity has chapters in the United States. At present Pennsylvania has four chapters. The purpose of Sigma Tau Sigma is to seek to promote social, cultural, scholarly, recreational and benevolent fraternal accomplishments among its members.

Meeting time: Every Monday, 8:15 — 9:15 p.m.

## Alpha Gamma Delta

Advisers ..... Mrs. Ruth Harris  
and Mrs. Reba Griffin  
President ..... Ruth A. Werren  
Secretary ..... Marietta Coleman

The Psi Chapter of Alpha Gamma Delta, a national sorority, was organized on the Edinboro campus in the fall of 1952. It is one of several chapters which are located throughout the United States.

Alpha Gamma Delta is an active member of the National Panhellenic Conference. Members are chosen on the basis of scholastic standing, abilities, personality and character. The aim of the sorority is to establish a sisterhood having for its five-fold objective, the physical, intellectual, social, ethical, and spiritual development of its members.

Meeting time: 2nd and 4th Mondays: 7:00 — 8:30 p.m.

## STUDENT CLUBS

### 'E' Club

Adviser ..... Mr. Arthur L. McComb  
President ..... Dave Hilbert

The "E" Club is an organization composed of all participants in Intercollegiate Athletics who have earned the Varsity "E". The outstanding social function of this organization is the annual staging of the "E" Club Ball on Homecoming Day.

### Kiltie Fins

Adviser ..... Miss Nancy Acker  
President ..... Daryl Craig  
Secretary ..... Kay Smith

The Kiltie Fins is the Synchronized Swimming Club. Instruction is given in synchronized swimming skills, and an effort is made to develop grace, creativeness and ability in swimming strokes and skills.

The club is open to all students who are interested in trying out at the beginning of the semester. The group prepares an annual Water Pageant in the spring of the year.

Meeting time: Wednesday, 7:00 — 8:30 p.m.

### Pep Club

Adviser ..... Miss Nancy Acker  
President ..... Mary Lou Morelli

The purpose of the Pep Club, a cheerleaders' organization, is to promote school spirit on campus. Membership is open to any male or female student who shows cheering ability.

The club is divided into two squads. Before joining the Varsity, the members must serve for one year on the Junior Varsity squad. Awards are presented to members on the basis of service to the organization.

Meeting: Monday 7:00 — 8:30 p.m.

## Red Cross Intercollegiate Council

Sponsors .. Mr. James P. Coffman  
and Mrs. Helen Nicely  
Pat Antonik  
President ..  
Secretary .. Mary Ann Graham

The purpose of The Council is to acquaint students with the aims and objectives of the American Red Cross and its many services in our American society. Edinboro members work with students of neighboring colleges.

In serving the Red Cross, the student gains the satisfaction of serving others. The organization meets every third Tuesday of the month, in Loveland Hall 13 at 6:00 p.m.

## CHURCHES AND RELIGIOUS ORGANIZATIONS

### Church Services

The Edinboro Churches offer students a variety of religious and social activities. The Young Peoples' groups hold weekly meetings, discussion groups, suppers, etc. Many students sing in the church choirs or serve as ushers throughout the school year. A cordial invitation is extended to all students to continue their religious affiliations with the churches.

### Advent Christian Church, 308 Erie Street

Rev. James Murray Hanna, Minister

#### Sunday Services

9:45 a.m. .... Sunday School  
10:55 a.m. .... Morning Worship  
7:30 p.m. .... Unified Service  
Youth Fellowship Worship  
Week-day Services  
8:00 p.m. .... Prayer Meeting

### Baptist Church, 117 Waterford Street

Rev. Linford C. Wilcox, Minister

#### Sunday Services

10:00 a.m. .... Sunday School  
(College Classes)  
11:00 a.m. .... Morning Worship  
7:00 p.m. .... Young Peoples  
8:00 p.m. .... Evening Services  
9:00 p.m. .... Choir Rehearsal

#### Weekday Services:

Wednesday — 8:00 p.m. .... Prayer Service  
Wednesday — 9:00 p.m. ... Choir Rehearsal  
Saturday — 7:30 p.m. ... Youth Activities  
Night

### Episcopal Church, St. Peter's, Waterford, Pa.

Rev. Ralph N. Parkhill, Vicar

8:00 a.m., Each Sunday . Holy Communion  
11:00 a.m., 1st Sun. of Mon., Holy Communion  
11:00 a.m., Other Sundays  
Morning Prayer and Sermon  
10:30 a.m., Thursday Weekday Communion  
Special Services as announced.

### Jewish Reformed Synagogue, 12th and Liberty Streets, Erie

Randell Falk, Rabbi

Friday Night Services ..... 8:00 p.m.  
Saturday Morning Services .. 9:00 p.m.

### Jewish Conservative Synagogue, 32nd and State Streets, Erie

Aaron Landes, Rabbi

Saturday Services ..... 8:00 a.m.  
Daily Morning Services ..... 7:30 a.m.  
Daily Evening Services ..... ½ hour before  
... sunset.

**Lutheran Church, St. Paul's, Drakes Mills**

Rev. Ralph E. Blair

**Sunday Services**

9:45 a.m. .... Sunday School  
11:00 a.m. .... Worship Services

**Methodist Church, Meadville Street**

Rev. S. James Schmittle, Pastor

**Sunday Services**

9:45 a.m. ... Wesley College Fellowship  
at the parsonage, 66 Meadville St.  
11:00 a.m. .... Divine Worship  
**Weekday Services**  
Wednesday — 7:30 p.m. Choir Rehearsal  
Students Welcomed  
Thursday (1st and 3rd) — 7:00 p.m.  
Wesley College Fellowship

**Presbyterian Church, Meadville Street**

Rev. William Allman, Pastor

**Sunday Services**

9:45 a.m. Westminister Collegiate  
Fellowship Breakfast Club  
11:00 a.m. .... Morning Worship

**Roman Catholic Church, Our Lady of the Lake  
Maple Drive**

Rev. George H. Dwyer, Priest

8:00 a.m. and 10:00 .. Sunday Masses  
7:00 a.m. .... Daily Mass  
7:00 p.m. .... Confessions  
(Every Saturday)

**RELIGIOUS ORGANIZATIONS**

**Canterbury Club**

Advisers .....  
Miss C. F. Whitney, Mr. L. C. Vincent  
President ..... Lawrence Morris  
Secretary ..... Sandra Fletcher

The Canterbury Club is an organization of Episcopalians students and faculty and others who are interested in its activities. These include social and religious programs of study and discussion. Meetings, NH 1, 1st and 3rd Thursday, 7:00 p. m.

**COLLEGE CHRISTIAN FELLOWSHIP**

Adviser ..... Rev. Linford Wilcox  
President ..... Barb Binkley  
Secretary ..... Vivian Mikolon

The College Christian Fellowship is an organization of Christian students who meet together for Bible study. The group also holds various types of entertainment designed to promote fellowship for Christian students.

Meeting time: Every Thursday, 7:30 p.m. in NH 4.

**LUTHERAN STUDENT ASSOCIATION**

President ..... Jack Adams  
Adviser ..... Pastor Ralph E. Blair

The Lutheran Student Association is the organization established for Lutheran students throughout colleges and universities in the United States. It gives Lutheran students an opportunity to become acquainted and to discuss their faith together. Both social and devotional meetings are held. Meetings may be conducted by the students or a guest speaker.

Meetings, Lutheran Parsonage, Hilltop Road, 1st and 3rd Tuesday, 7:00-8:30.

## NEWMAN CLUB

President ..... Richard Timny  
Advisers ..... Mr. Carl E. Wozniak,  
Mr. Aime Doucette

The Newman Club, an established institution of American colleges and universities, is an organization planned to fill the spiritual, intellectual and social needs of the Catholic students on the campus. The club belongs to the Middle Atlantic Province and each year sends delegates from this club to both Regional and Province conventions.

Meeting time: 1st and 3rd Thursday, 7:00-8:30 p.m.

## WESLEY COLLEGE FELLOWSHIP

President ..... Bernard Sarvis  
Sec.-Treas ..... Joyce Schiedemantle  
Advisers .. Rev. S. James Schmittle,  
Mrs. E. R. LaFollette

The Wesley College Fellowship is part of the world-wide Methodist Student Movement. It exists to provide an opportunity for worship, study, and fellowship among the Methodist students. Activities include a breakfast club each Sunday morning at 9:45 a.m. at the local Methodist parsonage, 66 Meadville Street, and evening meetings on the first and third Thursdays at the local Methodist Church from 7:00 until 8:30 p.m. Students of any denomination are welcome to join in the regular devotional and social meetings.

## WESTMINSTER COLLEGIATE FELLOWSHIP

Adviser ..... Mr. James Coffman  
Moderator ..... Jean Leo  
Stated Clerk ..... Dianne Elliott

The Westminster Collegiate Fellowship is an organization of Presbyterian students. The group's activities include Thursday evening meetings and a Sunday morning breakfast club.

Meeting time: 1st and 3rd Thursdays, 7 p.m. at the Edinboro United Presbyterian Church.

# SPORTS

## STUDENT ATHLETIC PROGRAM

### Women's Athletic Association

Adviser ..... Miss Nancy Acker

The Women's Athletic Association is a member of the Athletic Federation of College Women. It also is a member of the United States Field Hockey Association. The type of recreation is carefully chosen for the complete development and enjoyment of each student.

Every woman student, upon entering college is elected to membership automatically. Throughout the year there is regular intramural competition between teams set up by W. A. A.

Fall sports, outdoors, consist of field hockey, tennis and hiking; winter activities include skiing, skating, basketball, swimming, life saving, badminton, ping pong, and bowling; spring sports, outdoors, are archery, tennis, golf, hiking, softball.

The W. A. A. is governed by a student council which meets bi-monthly to plan and guide all activities. The program of the Association is based on a point system. Awards are presented at the Recognition Day ceremonies in May.

Activities: Tuesday and Thursday, 3:45-5:00 p.m.

### Men's Athletics

Advisers ..... Mr. Arthur McComb,  
Mr. Samuel Cianflocco, Mr. Robert W.  
Thurbon and Mr. Ronald McIntyre

The men's intercollegiate athletic program includes intercollegiate competition in wrestling, football, basketball, golf, track and tennis.

## Intramural Sports

The college has expanded the intramural program so that every student will have the opportunity of participating in his favorite sport. Besides the above mentioned sports, the college is equipped for badminton, ping-pong, volleyball, softball, and many others.

### Eligibility Rules

Edinboro is a member of the Pennsylvania State Teachers College Athletic Conference. Eligibility rules are regulated by action of the Board of Presidents of the Pennsylvania State Teachers Colleges. The following rules were passed May 18, 1948, and revised March 26, 1956.

- A. Responsibility. The President of each College shall be responsible for its athletic program. He or his authorized representative shall accompany any team which represents the college in any athletic contest.
- B. Certified Eligibility Lists. At least four days before every official game, eligibility lists, certified by the President of the competing colleges, shall be exchanged on forms provided by the conference secretary.
- C. Eligibility.
  1. A student shall not be allowed more than four years of inter-collegiate competition.
  2. A student must complete his intercollegiate competition within a five-year period from the date of first matriculation at any college. This restriction may be waived in the case of a veteran or draftee. The year or years during which a student may have represented any college as a service trainee in intercollegiate athletics competition shall not count in his total years of eligibility.

Interpretation: In determining years of competition in all cases, the following program applies: Participation, however brief, in any intercollegiate athletic competition in any college or junior college will cause that year to count as one of the allotted years of competition.

### 3. Academic Attainment

- a. A student to be eligible must carry at least twelve semester hours of credit courses.
  - b. A student to be eligible must have secured passing grades in at least twelve semester hours of work during his preceding semester. A student having failed to pass twelve semester hours in any semester may become eligible by attending summer sessions and securing a passing grade in twelve semester hours of credit.
4. No transfer student shall be eligible for intercollegiate athletic competition in varsity sports until he has completed satisfactorily a full year's or two semesters' work at his college.

#### Interpretations:

- a. Attendance at summer sessions shall not be regarded as meeting the requirements of a semesters' residence.
- b. The student who trains at a training camp with a college before the football season opens but who does not matriculate at the college is eligible to enter a teachers college and play that season. Matriculation means payment of fees, completion of registration forms and attendance at one class.
- c. A student transferring from a regularly accredited junior college shall not be affected by this rule.



5. Amateur Rule. A student competing in intercollegiate athletics shall be an amateur in good standing. An amateur sportsman is one who engages in sports for the physical, mental, or social benefit he derives therefrom, and to whom the sport is an avocation. A student ceases to be an amateur and is therefore ineligible to participate in intercollegiate competition by the commission of any of the following acts:

- a. Participation in any athletic competition under an assumed name, or otherwise with intent to deceive.
- b. Directly or indirectly receiving money or remuneration for participation in any competition as a player or for coaching any sport.
- c. Directly or indirectly receiving money for signing a contract with a professional team in any sport.
- d. Signing a contract with a professional team in any sport, regardless of any subsequent cancellation or revocation, absence of payment, or lack of training with the team.

6. A student who is a squad member on the date of the first regularly scheduled contest and who engages in any athletic contest during a time the college is in session not arranged or sanctioned by his college shall not be eligible to represent his college in that sport during that semester, and he shall also be ineligible for the ensuing season in the sport in which he participated in an unauthorized contest. This includes Thanksgiving vacation and between semesters, but does not include Christmas vacation.

D. Varsity Competition. A teachers college varsity team may compete only with varsity teams of four-year degree granting colleges in regularly scheduled games.

Interpretations:

1. Regularly scheduled games are games for which contracts are signed and, or admission charged.
2. Where scheduling difficulties are encountered, this rule may be waived by the Athletic Committee of the Board of Presidents.

E. Playing and Practice Season.

1. Pre-season practice in football shall not begin prior to September first of each year or prior to three weeks before the first regularly scheduled game, whichever is earlier, and the regular playing schedule shall be limited to a maximum of ten games in a season, exclusive of post-season competition.
2. Pre-season practice in basketball shall not begin prior to October 15; the first scheduled game shall not be played prior to December first, and the maximum number of regularly scheduled games shall not exceed twenty-six in a season, exclusive of post-season tournament contests.
3. Organized post-season practice in football shall be limited to twenty sessions in a period of thirty-six calendar days, vacation and examination days excluded.
4. Organized post-season practice in basketball shall be limited to twenty sessions in a period of thirty calendar days, vacation and examination days excluded.

## ATHLETIC SCHEDULE

### FOOTBALL SCHEDULE 1959

September 19, 1959	Clarion	Home
September 26, 1959	Slippery Rock	Away
October 3, 1959	Indiana	Home
October 10, 1959	St. Vincent	Away
October 17, 1959	Lock Haven	Home
October 24, 1959	Mansfield	Away
October 31, 1959	Hiram	Away
November 7, 1959	California	Away

### BASKETBALL SCHEDULE 1959-60

Sat., Dec. 5, 1959	Thiel	Home
Tues., Dec. 8, 1959	Alliance	Home
Fri., Dec. 11, 1959	Indiana	Away
Sat., Dec. 12, 1959	Fredonia	Home
Tues., Dec. 15, 1959	Clarion	Away
Fri., Jan. 8, 1960	California	Home
Sat., Jan. 9, 1960	Indiana	Home
Wed., Jan. 13, 1960	Grove City	Away
Fri., Jan. 15, 1960	Slippery Rock	Home
Fri., Feb. 5, 1960	Grove City	Home
Sat., Feb. 6, 1960	Fredonia	Away
Tues., Feb. 9, 1960	Alliance	Away
Fri., Feb. 12, 1960	California	Away
Sat., Feb. 13, 1960	Slippery Rock	Away
Tues., Feb. 16, 1960	Clarion	Home
Sat., Feb. 20, 1960	Lock Haven	Away
Tues., Feb. 23, 1960	Open	
Feb. 26 & 27, 1960	Open Away	
March 2, 1960	Thiel	Away
March 4, 1960	Lock Haven	Home

### WRESTLING SCHEDULE 1959-60

Sat., Jan. 9, 1960	Lock Haven	Home
Sat., Jan. 16, 1960	Western Reserve	Home
Sat., Jan. 30, 1960	Baldwin-Wallace	Away
Sat., Feb. 6, 1960	California	Home
Tues., Feb. 9, 1960	Slippery Rock	Away
Sat., Feb. 13, 1960	Quadrangular meet at Hiram	Away
Sat., Feb. 20, 1960	Indiana	Away
Wed., Feb. 24, 1960	Thiel	Home
Mar. 4 & 5, 1960	State Teachers College Championship	Lo k Haven
Mar. 11 & 12, 1960	41 Championships	Cleveland

### TRACK SCHEDULE 1959-60

Wed., April 22	Allegheny	Allegheny
Thurs., Fri., & Sat., April 23-24-25	Penn Relays	Philadelphia
Sat., May 2	Slippery Rock	Slippery Rock
Mon., May 4	Grove City	Grove City
Sat., May 9	State Teacher's College Championship	Millersville
Tues., May 12	Thiel	Edinboro
Sat., May 16	Tri-State Championship	Westminster

### GOLF SCHEDULE 1959-60

Tues., April 21	Thiel	Thiel
Fri., April 24	Gannon	Gannon
Mon., April 27	Clarion	Culbertson
Tues., May 5	Fredonia	Culbertson
Thurs., May 8	Clarion and California	Clarion
Mon., May 11	Thiel	Culbertson
Tues., May 12	Gannon	Culbertson

### TENNIS SCHEDULE 1959-60

Wed., April 30	Fredonia	Fredonia
Sat., May 2	Clarion	Edinboro
Wed., May 6	Gannon	Edinboro
Sat., May 9	Clarion	Clarion
Mon., May 11	Alliance	Edinboro
Wed., May 13	Gannon	Gannon
Thurs., May 14	Grove City	Edinboro
Sat., May 16	Alliance	Camb. Spgs.

All home contests will be played at College courts except for home golf matches which will be held at Culbertson Country Club.

## SONGS AND CHEERS

### Victory Song

On you old Red Raiders!  
Beat those darned invaders  
And march on to Victory.

Down the floor we'll thunder,  
We'll put them asunder  
And march on to Victory.

Dribble, dribble, dribble down the floor,  
Onward, onward, piling up the score.  
Sun will shine tomorrow,  
For we've won — E. S. T. C.  
Dick Rockwell '43  
Jack Alton '44

### Pep Song

Edinboro College, we will sing to you,  
We'll defend your standards  
In whate'er we do.  
Hail, Hail, the gang's all here!  
Round thy colors bright  
We'll stick together for the  
Crimson and white.

### Touchdown Song

Touchdown, that's the thing we want —  
a touchdown!  
That's the thing we want — a great big  
bruiser,  
Husky and tall, to carry the ball  
In no time at all!  
We want a touchdown! And when it's over,  
Let us hear you make some NOISE!  
V-I-C-T-O-R-Y  
We want a touchdown, boys!

### Hello Cheer

Hello (opponent)! Edinboro says "Hello!"  
Hi!

### Two Bits

Two bits, four bits, six bits, a dollar!  
Everyone from Edinboro, stand up and  
holler!

### 15 Rahs

Rah, rah, rah, — rah — rah!  
Rah, rah, rah — rah — rah,  
Rah, rah, rah — rah — rah!  
Yeah, Team!

### Dynamo

Dynamo, let's go  
Dnamite, let's fight,  
Dynamo, Dynamite  
Let's go, let's fight!

### Rah Team

Rah team, fight, fight!  
Rah team, fight, fight!  
Rah team, fight, fight!  
Fight! Team Fight!

### Shout Raiders

Shout, Raiders! Shout — Hallelujah!  
Shout, Raiders! Shout — Hallelujah!  
Shout, Raiders Shout — Hallelujah  
Shout, Raiders! Shout!

### T-E-A-M

T-E-A-M! Fight, fight, fight, fight!  
T-E-A-M! Fight, fight, fight, fight!  
T-E-A-M! Fight, fight, fight, fight!  
Fight, team, fight!

### Pep Steam

We've got the pep! (Clap, Clap)  
We've got the steam! (Clap, Clap)  
We've got the Coach! (Clap, Clap)  
We've got the team!

We've got the pep! (Clap)  
We've got the steam! (Clap)  
We've got the coach! (Clap)  
We've got the team (Clap)  
Yeah team! Say Team!  
Fight, team, fight!

### Victory

Victory, Victory  
Is our cry.  
V-I-C-T-O-R-Y  
Are we in it?  
You're doggone right!  
Edinboro, Edinboro,  
Fight, fight, fight!

### Red Hot

We all got together,  
and this is what we said,  
"Our team is red hot,  
"Our team is red hot,  
Our team is red,  
Our team is hot,  
Our team is red hot."

### Let's Go

Let's go Edinboro!  
(Two long claps, three short)  
(repeat three times)  
Let's Go!

### Raiders Fight

Raiders fight!  
Raiders fight!  
Fight, Fight!  
(three silent counts)  
FIGHT!

### Yea Team

Yea, team!  
Fight, fight!  
(Repeat three times)  
FIGHT!

### BASKETBALL CHEERS

#### Stomp Clap

(Stamp, clap — three times)  
Go team go!  
Fight team fight  
Win team win!  
Go — Fight — Let's win!

#### Dribble To The Left

Dribble to the left,  
Dribble to the right,  
Dribble down the center,  
Fight, fight, fight!

#### Clap Your Hands

Clap your hands,  
Stamp your feet,  
Edinboro College can't be beat!

#### Tip Off

Tip off the center,  
Dribble down the floor  
Shoot it in the basket,  
Score, score, score!

# CALENDAR

September 12, 1959

## Orientation of Freshman

Freshmen arrive 2 p.m.  
Faculty-Student Dinner 6 p.m., Haven Hall.  
Freshman Mixer, Crawford Gym 8:30 - 11:30.

September 13-19, 1959

13. Sunday Church Services; Dinner, 12:30 p.m., Dining Room; Picnic, Sunset Camps 2-7 p.m.; Vesper Services, 8:30, College Athletic Field.

14. Freshmen Meeting, Auditorium, 8 a.m.; Registration and Medical Examinations 8:30; Open House in gymnasium after Registration.

15. Freshmen Meeting, Auditorium, 9 a.m.; Registration of Upper Classmen, 8 a.m. - 5 p.m.; Freshmen Meeting, Auditorium 1 p.m.; Meetings - Collegiate Players, Band, Photo Club, Red Cross.

16. Classes begin at 8:00 a.m. Readings for the play "Julius Caesar". (Rehearsals for the play "Julius Caesar" begin Monday, Wednesday, and Friday (until the play) from 7:00 to 10:00 p.m.) Meetings: Beta Beta Beta, Zeta Tau, Student Council Social Committee Meeting, College Band tryouts, Student Council Meeting.

17. Readings for "Julius Caesar". Canterbury Club, English Club, Lutheran Student Association, College Christian Fellowship, Newmen Club, Wesley College Fellowship, Delta Sigma Phi, Womens Athletic Association.

September 18

18. Readings for "Julius Caesar"; Tryouts for the Collegiate Chorale; College Band Tryouts; Conneauttee Meeting at 3:45 in Normal Hall.

September 19

19. Football vs. Clarion, College Field, Parents Day.

September 20-26, 1959

20. Theta Sigma Upsilon Student Teacher Breakfast; Delta Phi Delta Freshman tea for Art Students at 2:00 p.m. in Bates Gallery.

21. Phi Sigma Pi Meeting. Alpha Delta Iota Welcome Back Picnic for Student Teachers.

22. Edinboro Collegiate Players Meeting; Theta Sigma Upsilon, Alpha Delta Iota, Delta Sigma Phi Smoker; W.A.A., Photography Club, Delta Phi Delta.

23. Alpha Phi Omega Smoker; Phi Sigma Pi Smoker; Assembly, Dr. Miller presenting faculty to students.

24. Pep Club tryouts end. Movie 7 p.m. Memorial Auditorium. All movies are at 7 p.m. in the Memorial Auditorium. Physical Science Club; Mu Kappa Gamma.

25. Conneautteean Meeting.

26. Football at Slippery Rock; Delta Sigma Phi "Bermuda" Steak Fry; Student Council Square Dance.

September 27 - October 3, 1959

27.

28. Sigma Tau Sigma Smoker; Phi Sigma Pi Educational Meeting, guest speaker; Phi Sigma Pi Help Week begins.

29. Edinboro Collegiate Players Meeting; Social Studies Club Banquet; Geography Club Meeting; Music Organizations Picnics, W.A.A.; Photography Club.

30. Big and Little Sister Reception; Zeta Tau Fall Picnic.

Oct. 1. Religious Clubs Meetings.

2. Conneauttean Meeting.

3. HOMECOMING DAY: Parade at 1 pm All Freshmen to march Football vs. Indiana at College Field, 2:30 pm "E" Club Ball Dance at 9 pm. Crawford Gymnasium.

October 4-10, 1959

4. Phi Sigma Pi Help Week Ends; Theta Sigma Upsilon Pledge Service.

5. Edinboro Collegiate Players; Sigma Tau Sigma pledge week begins; Phi Sigma Pi "Educational" Meeting; Theta Sigma Upsilon; Alpha Delta Iota meeting.

6. PSEA meeting; W.A.A. meeting; Photography Club; Delta Phi Delta.

7. Zeta Tau meeting; Student Council meeting; Mrs. Jack Laver, concert.

8. Canterbury Club Meeting; English Club Meeting; Delta Sigma Phi; Physical Science Club Meeting; Mu Kappa Gamma Meeting; Movie, Auditorium.

9. Kappa Delta Pi 7 p.m.; Pep Club Bon-Fire Rally; Tennis Courts at 8:30 p.m.; Basketball tryouts begin; Conneauttean Meeting.

10. Sigma Tau Sigma pledge week ends; Football at St. Vincent College, Latrobe, Pa., Alpha Phi Omega Hayride; Delta Sigma Phi Bowling Party; Northwestern Pennsylvania Classroom Teachers' Conference.

October 11-17, 1959

11

12. Edinboro Collegiate Players; Phi Sigma Pi Meeting.

13. Geography Club meeting; W.A.A.; Photography Club.

14. Phi Sigma Pi Formal Initiation Banquet.

15. Canterbury Club; Lutheran Student Association; Wesley College Fellowship; Delta Sigma Phi; Women's Athletic Association; Delta Phi Delta Art Conference.

16. Conneauttean Meeting.

17. Football vs. Lock Haven on College Field, 2 p.m.

October 18-24, 1959

18.

19. Edinboro Collegiate Players; Phi Sigma Pi Educational Meeting; Alpha Delta Iota Pledge Service; Dr. Tim Stinnett, lecturer.

20. Women's Athletic Association Meeting; Photography Club meeting; Red Cross Intercollegiate Council Meeting; Delta Phi Delta Meeting.

21. Beta Beta Beta; Zeta Tau Fall Pledge Service; Student Council Meeting.

22. Canterbury Club; Movies, Auditorium, 7 p.m.; Delta Sigma Phi Meeting; Women's Athletic Association Meeting; Physical Science Club Meeting; Mu Kappa Gamma.

23. Panhellenic Assembly 3rd period Auditorium; Conneautteean Meeting.

24. Football at Mansfield STC; Delta Sigma Phi "Carnation" Ball.

October 25-31, 1959

25. Women's Dorm Council "Fall Tea".

26. Edinboro Collegiate Players; Alpha Delta "Founders Day" Banquet and Formal Initiation; Phi Sigma Pi Meeting.

27. Geography Club; Women's Athletic Association; Photography Club.

28. Ludwig Olshansky, pianist, concert.

29. Canterbury Club; Delta Sigma Phi; Women's Athletic Association.

30. Conneautteean.

31. Football at Hiram (O.) College; Sigma Tau Sigma "Fall Capers" dance.

November 1-7, 1959

1.

2. Collegiate Players

3. PSEA meeting; Geography Club; Women's Athletic Association; Photography Club; Delta Phi Delta.

4. Zeta Tau; Student Council.

5. Canterbury Club; S.S.A.; College Christian Fellowship; Newman Club; Wesley College Fellowship Delta Sigma Phi; W.A.A.

6. Conneautteean.

7. Football at California STC; Sigma Tau Sigma Hayride; Delta Sigma Phi "Egyptian" Ball.

November 8-14, 1959

8.

9. Edinboro Collegiate Players; Phi Sigma Pi "Sadie Hawkins Week" begins; Theta Sigma Upsilon; Alpha Delta Iota; Phi Sigma Pi.

10. W.A.A.; Photography Club.

11. Student Council Social Committee meeting.

12. "Julius Caesar", 8:15 Auditorium; Canterbury Club; English Club; Panhellenic evening meeting for freshman girls; W.A.A.; Physical Science Club; Mu Kappa Gamma.

13. "Julius Caesar", 8:15 p.m., Auditorium; Kappa Delta Pi; Conneautteean.

14. "Julius Caesar", 2 p.m., Auditorium; Phi Sigma Pi "Sadie Hawkins" dance; Quarter payments due in the Bursar's office on or before this date.

#### November 15-21, 1959

15. Theta Sigma Upsilon.

16. Edinboro Collegiate Players meeting; Phi Sigma Pi "Educational Meeting", guest speaker; Alpha Delta Iota Birthday Party; Theta Sigma Upsilon Pledge Banquet.

17. Geography Club; W.A.A.; Photography Club; Red Cross Intercollegiate Council; Delta Phi Delta.

18. Beta Beta Beta; Zeta Tau; Student Council.

19. Canterbury Club; Lutheran Student Association; College Christian Fellowship; Newman Club; Wesley College Fellowship; Delta Sigma Phi; W.A.A.

20. Panhellenic Assembly 3rd period, Auditorium; Conneautteean.

21. Alpha Phi Omega Formal initiation banquet.

#### November 22-28, 1959

22.

23. Edinboro Collegiate Players; Theta Sigma Upsilon; Alpha Delta Iota; Phi Sigma Pi.

24. Thanksgiving Recess begins at close of classes.

25. Vacation

26. Vacation

27. Vacation

28. Vacation

#### November 29-December 5, 1959

29. Vacation

30. Thanksgiving recess ends at 8:00 a.m.

Dec. 1. Edinboro Collegiate Players; PSEA; Geography Club; W.A.A.; Photography Club; Delta Phi Delta.

2. Zeta Tau Christmas Project; Student Council

3. Canterbury Club; Lutheran Student Association; College Christian Fellowship; Newman Club; Wesley College Fellowship; Delta Sigma Phi; W.A.A.

4. Conneautteean.

5. Sigma Tau Sigma Formal Initiation banquet; Basketball, Theil College, Crawford Gymnasium; Alpha Phi Omega Sleigh Ride.



December 6-12, 1959

6. Collegiate Band Concert, 3:00 p.m., Memorial Auditorium.
7. Theta Sigma Upsilon; Alpha Delta Iota.
8. Edinboro Collegiate Players; Hanging of the Greens; Basketball, Alliance College, Crawford Gym; W.A.A.; Photography Club.
9. Wrestling, Lock Haven STC, Crawford Gym Zeta Tau Christmas Party; Delta Sigma Phi; Student Council Social Committee.
10. Canterbury Club; English Club; Movies, 7 p.m., Auditorium; W.A.A.; Physical Science Club; Mu Kappa Gamma.
11. Basketball at Indiana STC; Kappa Delta Pi; Conneautteean.
12. Basketball at Fredonia (N.Y.) STC; Student Council Christmas Dance.

December 13-16, 1959

13. Collegiate Choral Vesper Service.
14. Phi Sigma Pi; Alpha Delta Iota Christmas Party; Theta Sigma Upsilon Christmas Party.
15. Edinboro Collegiate Players; Geography Club; Beta Beta Beta; Theta Sigma Upsilon Apecila Summer Project; Wrestling tryouts begin; W.A.A.; Photography Club; Red Cross Intercollegiate Council; Delta Phi Delta; Basketball at Clarion STC.
16. Christmas Recess begins at close of classes.

December 17, 1959-January 3, 1960

Christmas Vacation.

January 4-9, 1960

4. Christmas Recess ends at 8:00 a.m.; Readings for "South Pacific"; Theta Sigma Upsilon; Alpha Delta Iota.
5. Readings for "South Pacific"; PSEA; W.A.A.; Photography Club; Delta Sigma Phi.
6. Readings for "South Pacific"; Zeta Tau; Student Council.
7. Readings for "South Pacific"; Canterbury Club; Lutheran Student Association; College Christian Fellowship; Newman Club; Wesley Christian Fellowship; Delta Sigma Phi; W.A.A.
8. Readings for the "South Pacific"; Basketball, Indiana STC, Crawford Gym, 8 p.m.; Kappa Delta Pi; Conneautteean.
9. Readings for "South Pacific"; Alpha Psi Omega Initiative Banquet; Basketball, California STC, Crawford Gym, 8 p.m.

January 10-16, 1960

- 10.
11. Phi Sigma Pi; Delta Sigma Phi; Delta Mu Revue".
12. Edinboro Collegiate Players; Student Council; W.A.A.; Photography Club.
13. Basketball at Grove City College; Panhellenic Party; Student Council Social Committee.

14. Canterbury Club; English Club; Delta Sigma Phi; W.A.A.; Physical Science Club; Mu Kappa Gamma; Randy Weston Jazz Quartet, 8:15.

15. Basketball at Slippery Rock STC; Theta Sigma Upsilon Special Courtesy Day Celebration; Conneauttean.

16. Sigma Tau Sigma dinner dance; Wrestling at Western Reserve U., Cleveland.

January 17-23, 1960

17.

18. Phi Sigma Pi Educational Meeting; Theta Sigma Upsilon; Alpha Delta Iota.

19. Edinboro Collegiate Players; W.A.A.; Photography Club; Red Cross Intercollegiate Council; Delta Phi Delta.

20. Beta Beta Beta Meeting; Zeta Tau; Student Council.

21. Canterbury Club; Lutheran Student Association; College Christian Fellowship; Newman Club; Wesley Collegiate; W.A.A.

22. Conneauttean Meeting; Final Exams.

23. Final Exams.

January 24-30, 1960

24.

25. Final Exams.

26. Final Exams; Edinboro Collegiate Players; Photography Club.

27. Final Exams.

28. Final Exams Being Administered; Fall Semester ends at Close of Classes.

29. Vacation

30. Vacation; Wrestling at Baldwin-Wallace College, Cleveland.

January 31-February 6, 1960

Jan. 31. Vacation

Feb. 1. Registration of Freshmen; Phi Sigma Pi; Theta Sigma Upsilon; Alpha Delta Iota.

2. Registration of Upperclassmen; SEAP; Geography Club; W.A.A.; Photography Club; Delta Phi Delta.

3. Classes begin at 8:00 a.m.; Zeta Tau; Student Council.

4. Canterbury Club; Lutheran Student Association; College Christian Fellowship; Newman Club; Wesley Fellowship; Delta Sigma Phi; Alpha Delta Iota.

5. Basketball, Grove City College, Crawford

Gym; Tryouts for the Collegiate Chorale; Student Council Winter Carnival, Skating at 8:00 p.m., Community sing at 10:00 p.m.; Conneauttee

6 Basketball at Fredonia (NY) STC; Wrestling vs California STC, Crawford Gym, 2 p.m.; Student Council Winter Carnival Snow Sculpture at 1:00 p.m. "Snow Ball" at 9 p.m. at Crawford Gymnasium

#### February 7-13, 1960

7. Theta Sigma Upsilon Student Teacher Breakfast

8. Phi Sigma Pi Educational meeting, movie; Alpha Delta Iota Party honoring student teachers; Delta Sigma Phi Smoker

9. Edinboro Collegiate Players; Wrestling at Slippery Rock STC 8 pm; WAA; Photography Club

10. Phi Sigma Smoker; Panhellenic Party; Lecturer, Philip Stern.

11. Canterbury Club; English Club; Movies, Auditorium, 7 pm; Delta Sigma Phi; WAA; Physical Science Club; Mu Kappa Gamma

12. Basketball at California STC; Wrestling; Quadrangular meet at Hiram (O) College; Kappa Delta Pi; Alpha Delta Iota Valentine Dance; Conneautteean

13. Basketball game at Slippery Rock STC 2 p.m.; Alpha Phi Omega Smoker; Freshman Class "Valentine Dance

#### February 14-20, 1960

14. Delta Phi Delta Pledge Service Begins

15. Phi Sigma Pi; Phi Sigma Pi Help Week; Theta Sigma Upsilon; Alpha Delta Iota

16. Edinboro Collegiate Players; Sigma Tau Sigma Smoker; Geography Club; Basketball, Clarion STC, Crawford Gym, 8 pm; WAA; Photography Club; Red Cross Council; Delta Phi Delta

17. Beta Beta Beta; Panhellenic Party; Sigma Tau Gamma Smoker; Student Council; Wrestling, Clarion STC, Crawford Gym, 8 p.m.

18. Canterbury Club; Lutheran Student Association; Newmen Club; Wesley College Fellowship; Delta Sigma Phi; W.A.A.

19. Delta Sigma Phi "Stag" Party; Conneautteean

20. Basketball at Lock Haven STC; Wrestling at Indiana STC; Phi Sigma Pi "Sleigh" Ride

#### February 21-27, 1960

21. Phi Sigma Pi Help Week Ends

22. Phi Sigma Pi Educational Meeting

23. Edinboro Collegiate Players; W.A.A.; Photography Club

24. Wrestling at Thiel College, Greenville, Pa.; Phi Sigma Pi Formal Initiation Banquet; Alpha Delta Iota Rush Party

25. Canterbury Club; Movies, 7 p.m., Auditorium; Delta Sigma Phi; W.A.A.; Physical Science Club; Mu Kappa Gamma

26. February Holiday Begins at Close of Classes Classes

27. No Classes; Wrestling at Clarion STC

*D*  
February 28-March 5, 1960

28. Vacation

29. Vacation  
Mar. 1. Holiday ends at 8:00 a.m.; Edinboro Collegiate Players; PSEA; W.A.A.; Photography Club; Delta Phi Delta Initiation Service and Banquet

2. Basketball at Thiel College, Greenville, Pa.; Theta Sigma Upsilon Rush Party; Zeta Tau; Student Council

3. Canterbury Club; Lutheran Student Association; College Christian Fellowship; Newmen Club; Wesley College Fellowship; Delta Sigma Phi; Women's Athletic Association

4. Basketball, Lock Haven STC, Crawford Gym; Conneauttean

5. Phi Sigma Pi Pledge Dance

March 6-12, 1960

6

7 Phi Sigma Pi Educational Meeting, Theta Sigma Upsilon, Alpha Delta Iota

8. Edinboro Collegiate Players; Geography Club; Women's Athletic Association; Photography Club

9. Zeta Tau Rush Party, Student Council Social Committee

10. English Club; Canterbury Club; Movies, 7 p.m., Auditorium; Delta Sigma Phi; Physical Science Club, Mu Kappa Gamma

11. Kappa Delta Pi; Conneauttean

12. Alpha Phi Omega Formal Initiation Banquet, Delta Sigma Phi Dinner Dance

March 13-19, 1960

13. —

14. Phi Sigma Pi, Alpha Delta Iota Pledge Service and Service Week Begins

15. Edinboro Collegiate Players; Women's Athletic Association, Photography Club, Red Cross Intercollegiate Council, Delta Phi Delta

16. Beta Beta Beta, Zeta Tau Informal Initiation Student Council; Robert St. John, Assembly, lecturer.

17. Canterbury Club, Lutheran Student Association, College Christian Fellowship, Newman

Club, Wesley College Fellowship, Delta Sigma Phi, Women's Athletic Association

18. Alpha Phi Omega Square Dance, Conneauttean

19. Sigma Tau Sigma Informal Ski Dance

March 20-26, 1960

20. Theta Sigma Upsilon Pledge Service

21. Alpha Delta Formal Initiation, Theta Sigma Upsilon

22. Edinboro Collegiate Players, Geography Club, Womens Athletic Association, Photography Club

23.—

24. Canterbury Club, Movies, 7 p.m., Auditorium, Delta Sigma Phi, Womens Athletic Association, Physical Science Club, Mu Kappa Gamma

25. Conneauttean Meeting

26. Student Council "Night Club" Dance, 8:00 p.m., Student Union

27.—

28. Phi Sigma Pi

29. Women's Athletic Association, Photography Club meeting

30. Zeta Tau Easter Project

31. Canterbury Club; Delta Sigma Phi, W.A.A.

April 1, 1960

1. Track tryouts begin, Golf tryouts begin, Tennis tryouts begin, Conneauttean

2. Quarter Payments due in the Burser's Office on or before this date, Theta Sigma Upsilon Pledge Dance, Delta Phi Delta "Beau Arts" Ball

April 3-9, 1960

3.—

4. Phi Sigma Pi Educational Meeting, Guest speaker, Alpha Delta Iota Birthday Party; Theta Sigma Upsilon

5. Edinboro Collegiate Players; PSEA; W.A.A.; Photography Club, Delta Phi Delta

6. Zeta Tau Formal Initiation Banquet; Student Council

7. "South Pacific", College Auditorium, 8:15 p.m.; Canterbury Club; English Club; Lutheran Student Association; College Christian Fellowship; Newman Club; Wesley College Fellowship; WAA; Northwestern Social Studies Conference

8. "South Pacific", College Auditorium, 8:15 p.m.; Kappa Delta Pi; Conneauttean

9. "South Pacific", College Auditorium, 2 p.m.; Sigma Tau Sigma "White Rose Dance"; Delta Sigma Phi "Squaw" Dance.

April 10-16, 1960

10.

11. Phi Sigma Pi; Junior Arts Conference.

12. Geography Club; W.A.A.; Photography Club; Junior Arts Conference.

13. Easter Vacation begins at close of classes. Junior Arts Conference.

14-16. Easter Vacation.

April 17-23, 1960

17-18. Easter Vacation.

19. Spring Recess ends at 8:00 a.m. Edinboro Collegiate Players; W.A.A.; Photography Club.

20. Beta Beta Beta; Zeta Tau; Student Council Social Committee; Warren Boys Choir, Assembly, concert.

21. Canterbury Club; Lutheran Student Association; College Christian Fellowship; Newman Club; Wesley College; W.A.A.

22. Conneautteean; Delta Phi Delta.

23. Interfraternity Council Ball

Page 106

April 24-30, 1960

24. Women's Dorm Council "Parents Tea"; Theta Sigma Upsilon Initiation.

25. Phi Sigma Pi; Theta Sigma Upsilon Pledge Banquet.

26. Edinboro Collegiate Players; Geography Club; W.A.A.; Photography Club.

27.

28. Canterbury Club; Theta Sigma Upsilon Fashion Show; Delta Sigma Phi; W.A.A.; Phy-

sical Science Club; Mu Kappa Gamma; Movie, Auditorium, 7 p.m.

29. Phi Sigma Pi Steak Fry; Conneautteean; Erie County Science Fair.

30. Sigma Tau Banquet; Erie County Science Fair.

May 1-7, 1960

1. Alpha Delta Parents' Day Tea; Zeta Tau Tea.

2. Phi Sigma Pi Educational Meeting, Guest Speaker; Theta Sigma Upsilon; Alpha Delta Iota.

3. Edinboro Collegiate Players; PSEA; W.A.A.; Photography Club.

Page 107

4. Zeta Tau Founders' Day Party; Student Council.

5. Canterbury Club; Theta Sigma Upsilon; College Christian Fellowship; Newman Club; Wesley College Fellowship; Delta Sigma Pi; W.A.A.

6. Junior-Senior Weekend; Conneautteean.

7. Junior-Senior Weekend.

May 8-14, 1960

8. Junior-Senior Weekend; Theta Sigma Upsilon Mothers' Day Tea.

9. Phi Sigma Pi.

10. Edinboro Collegiate Players; Geography Club; W.A.A.; Photography Club; Delta Pi Delta.

11. Student Council Social Committee.

12. Canterbury Club; English Club; Delta Sigma Pi; W.A.A.; Physical Science Club; Mu Kappa Gamma; Movie, Auditorium, 7 p.m.

13. Phi Sigma Pi Senior-Sports begins; Kappa Delta Pi; Conneautteean; Delta Phi Delta Clothesline Exhibit.

14. Sigma Tau Gamma picnic; Delta Sigma Pi "Sailors" Ball.

Page 108

May 15-21, 1960

15. Coffee Hour; Collegiate Band Concert at 7:30 p.m. in Memorial Auditorium.

16. Phi Sigma Pi; Theta Sigma Upsilon; Alpha Delta Iota.

17. Edinboro Collegiate Players; W.A.A.; Photography Club; Red Cross; Intercollegiate Council.

18. Beta Beta Beta; Zeta Tau Spring Picnic; Student Council; Awards Day; Assembly.

19. Canterbury Club; College Christian Fellowship; Newman Club; Wesley College Fellowship; Delta Sigma Phi; W.A.A.

20. Final Exams begin

21. Final Exams being administered.

May 22-28, 1960

22.

23. Final Exams.

24. Final Exams.

25. Final Exams

26. Final Exams.

26. Final Exams.

27.

28. Alumni Day; Alpha Delta Senior and Alumni Banquet.

May 29-30, 1960

29. Baccalaureate Service

30. Commencement.

Page 109

4. Zeta Tau Founders' Day Party; Student Council.

5. Canterbury Club; Theta Sigma Upsilon; College Christian Fellowship; Newman Club; Wesley College Fellowship; Delta Sigma Pi; W.A.A.

6. Junior-Senior Weekend; Conneauttean.

7. Junior-Senior Weekend.

May 8-14, 1960

8. Junior-Senior Weekend; Theta Sigma Upsilon Mothers' Day Tea.

9. Phi Sigma Pi.

10. Edinboro Collegiate Players; Geography Club; W.A.A.; Photography Club; Delta Pi Delta.

11. Student Council Social Committee.

12. Canterbury Club; English Club; Delta Sigma Pi; W.A.A.; Physical Science Club; Mu Kappa Gamma; Movie, Auditorium, 7 p.m.

13. Phi Sigma Pi Senior-Sports begins; Kappa Delta Pi; Conneauttean; Delta Phi Delta Clothesline Exhibit.

14. Sigma Tau Gamma picnic; Delta Sigma Pi "Sailors" Ball.

Page 108

May 15-21, 1960

15. Coffee Hour; Collegiate Band Concert at 7:30 p.m. in Memorial Auditorium.

16. Phi Sigma Pi; Theta Sigma Upsilon; Alpha Delta Iota.

17. Edinboro Collegiate Players; W.A.A.; Photography Club; Red Cross; Intercollegiate Council.

18. Beta Beta Beta; Zeta Tau Spring Picnic; Student Council; Awards Day; Assembly.

19. Canterbury Club; College Christian Fellowship; Newman Club; Wesley College Fellowship; Delta Sigma Phi; W.A.A.

20. Final Exams begin

21. Final Exams being administered.

May 22-28, 1960

22.

23. Final Exams.

24. Final Exams.

25. Final Exams

26. Final Exams.

26. Final Exams.

27.

28. Alumni Day; Alpha Delta Senior and Alumni Banquet.

May 29-30, 1960

29. Baccalaureate Service

30. Commencement.

Page 109



## INDEX

Absence and Tardiness	21
Academic Standards	19
Activity Schedule	55
Advisory Program	24
Alma Mater	2
Alpha Delta	67
Alpha Gamma Delta	70
Alpha Phi Omega (Service)	57
Alpha Psi Omega	57
Assembly	18
Athletic Schedules	82
Athletics, Men's	77
Athletics, Women's (W.A.A.)	77
Automobile Regulations	33
Band	65
Basketball Schedule	82
Beta Beta Beta	63
Boarding Facilities	29
Books and Supplies	29
Bus Service	29
Calendar of Events	88
Canterbury Club	75
Cheers and Songs	83
Church Services	72
Churches and Religious Organizations	72
Class Bell Schedule	18
Class Membership	19
Closing of Dormitories During Vacations	30
College Band	65
College President's Message	5
College Union	32
Collegiate Players	66
Collegiate Singers	66
College Christian Fellowship	75
Commuting Students	44
Conneautean, The	64
Constitution of the Student-Faculty Assn.	48
Daily Bulletin	33
Dean's List	19
Delta Phi Delta	63
Delta Sigma Phi	67
Dining Room Regulations	28
Dormitory Maintenance	39

## INDEX

Dramatics	66
E-Club	71
Employment on Campus	23
English Club	60
Extra-Curricular Program	30
Faculty and Staff Directory	9
Fire Regulations	45
Football Schedule	82
Foreward	3
Fraternity and Club Initiations	31
Fraternities and Sororities	67
(see individual name)	
Freshman Information	16
Geography Club	60
Golf Schedule	83
Guests in Dormitories	37
Guests in Dining Room	28
Handbook	65
Health and Infirmary Service	26
History of the College	8
Infirmary Service	26
Illness in Room	26
Inter-Fraternity Council	67
Intramural Sports	78
Kappa Delta Phi	68
Kappa Delta Pi	62
Kiltie Fins	71
Library	25
Loans	23
Lutheran Student Association	75
Mail Service	29
Map of Campus	56-57
Mu Kappa Gamma	62
Musical Organizations	65
Newman Club	76
Newspaper	64
Off-Campus Students	44
Parent's Permission	38
Pep Club	71
Phi Sigma Pi	68
Photography Club	60
Physical Science Club	61
President's Message	5

## INDEX

Probation .....	20
PSEA, Student .....	56
Red Cross Intercollegiate Council .....	72
Registration .....	18
Regulations for Men .....	41
Regulations, Commuting and Off-campus .....	44
Regulations for Women .....	36
Religious Organizations .....	72
Rho Sigma Chi .....	69
Scheduling Social Activities .....	34
Sigma Tau Sigma .....	70
Social Studies Club .....	61
Songs and Cheers .....	83
Spectator, The .....	64
Student Advising Program .....	24
Student Clubs .....	71
(see individual club names also)	
Student Employment .....	23
Student Government .....	48
Student President's Message .....	7
Student Professional Organizations .....	56
Student PSEA .....	56
Student Publications .....	64
Student Self-help .....	23
Tardiness and Absence .....	21
Telephone Service .....	14
Telephone, Faculty .....	9
Telephones, Campus .....	14
Tennis Schedule .....	83
Time Schedule of Classes .....	18
Tips to Freshmen .....	16
Track Team Schedule .....	83
Upper Division .....	20
Wesley Fellowship .....	76
Westminster Collegiate Fellowship .....	76
Withdrawal Procedure .....	19
Women's Dormitory Council .....	38
Wrestling Schedule .....	82
Yearbook .....	64
Zeta Tau .....	69